



Prepared by Goodhue County GIS Office

## Clay Bank (Ghost Town)

**LOCATION:** 22000 block 360<sup>th</sup> Street, Goodhue Township, Minnesota

**STATUS:** Public

**TYPE:** Historic, District

**HISTORY:** 1890's village site, community was established due to the clay mining industry railroad spurs in the area.

### OTHER RESOURCES:

[Meyer, Roy W., \*The Ghost Towns & Discontinued Post Office of Goodhue County\*, The Goodhue County Historical Society Press, Red Wing, MN, 2003](#)

### PROPERTY PICTURES:

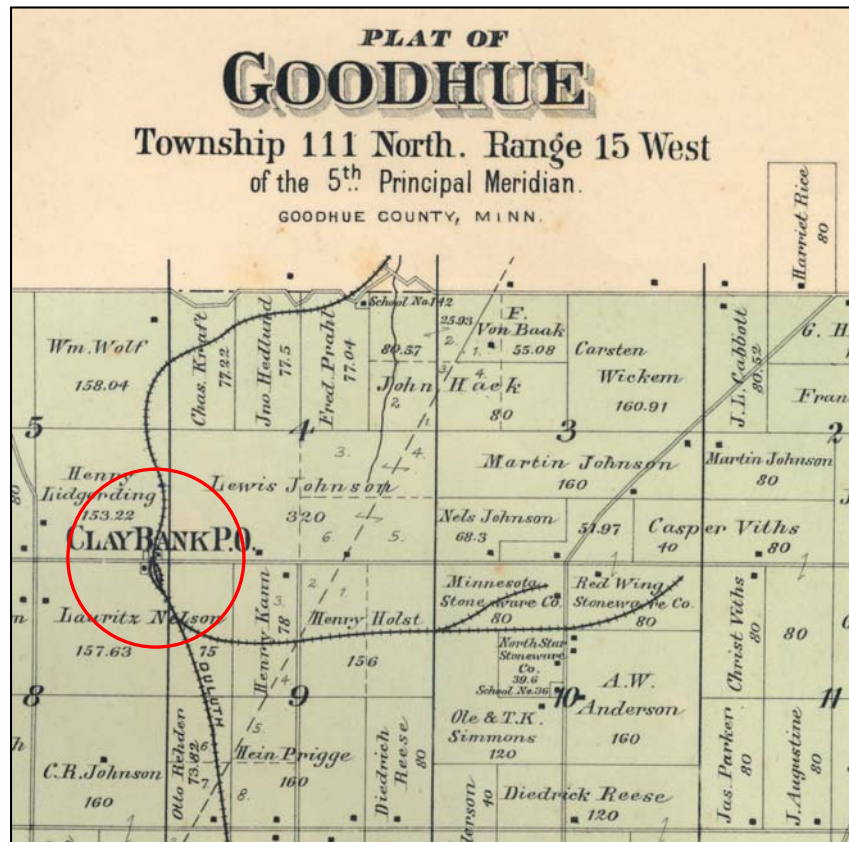

1894 Goodhue County Plat Book, Goodhue Township, Sections 3, 4, 9, 10



Goodhue County Picture, 2011