



Prepared by Goodhue County GIS Office

Claybank Pits – John Paul Pottery Site

LOCATION: Highway 58 and 350th Street, Goodhue Township, Minnesota

STATUS: Access Restricted – Private Property

TYPE: Local, Site

HISTORY: John Paul bought land in Goodhue Township where clay was identified and to supply his pottery business. John Paul Pottery was in operation from approximately 1862 to 1872. After the small pottery business utilized this clay resource, larger clay works operations bought the land for their businesses. The Minnesota Stoneware Company, Red Wing Stoneware Company and North Star Stoneware Company operated the clay pits. The clay was mined and shipped on railroad cars to the factories in Red Wing for pottery, sewer pipe, and tiles. A local historic marker is located by the intersection of Highway 58 and 350th Street, Goodhue Township, Minnesota.



Examples of John Paul pottery.

Picture courtesy of Red Wing Collectors Society

OTHER RESOURCES:

[John Schwartau, The Red Wing Clay Industry, How it all began, John Paul, 1819-1900](#)

PROPERTY PICTURES:

The John Paul Pottery Site

The birthplace of the Red Wing clay industry began in a former schoolhouse converted into a one-man pottery south of Red Wing off present day Highway 58 in 1862. The potter was John Paul, a German immigrant who bought the property in the early 1860's, installed a wheel and kiln and soon began turning out jugs, crocks, bowls and jars.

The John Paul Pottery was located about 250 yards east of the entrance to the lot. It was on the north side of the road and is now marked by a large pit overgrown with brush. The pottery was near the center of what became a 320-

acre clay pit area. After 10 years John Paul gave up his pottery business and moved to Shakopee, south of the twin cities of Minneapolis & St. Paul, where he continued as a potter but later became a brick mason.

The site of the John Paul pottery is marked with a sign installed by the Cannon Valley Red



Wing Collectors Chapter and can be visited by heading south out of Red Wing on Hwy 58. Go fourteen miles to 350th Street and turn left, watch for the historical marker sign, the location of the John Paul Pottery is 250 yards east of the Claybank Pits / John Paul Historical Markers.

Thanks to John Schwartau

of the Cannon Valley Red Wing collectors Chapter for his suggestion of the John Paul site story and for sharing his research information.

Red Wing Collectors Society Supplement, Red Wing Republican Eagle, July, 2000

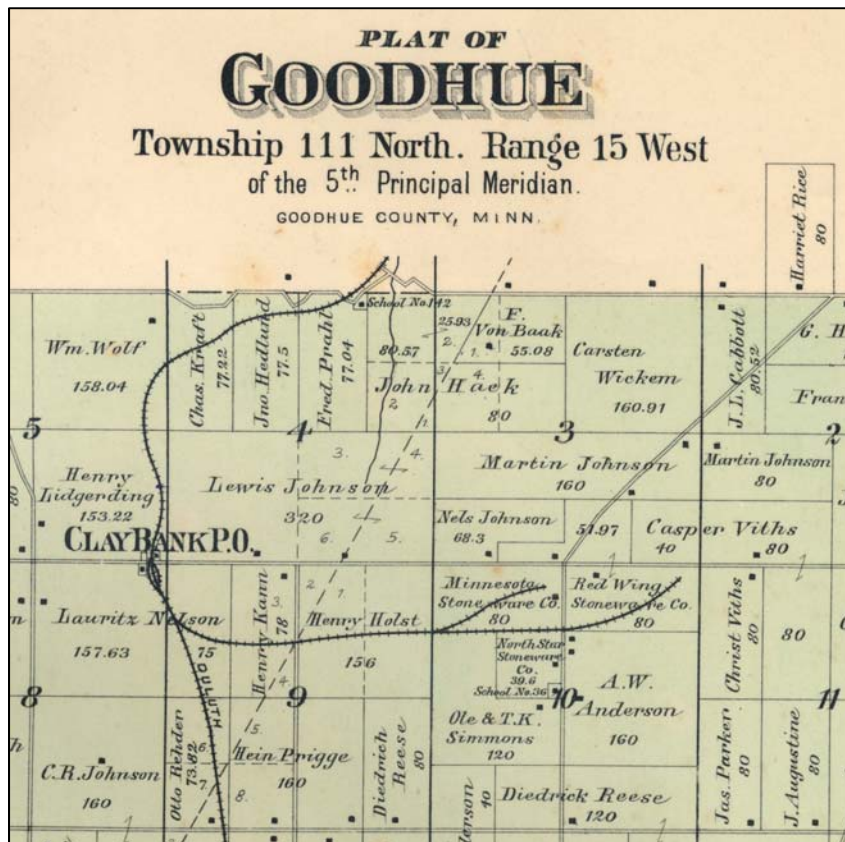

1894 Goodhue County Plat Book, Goodhue Township, Sections 3, 4, 9, 10



Typical Goodhue County clay pit mining operation, 1880's, Picture courtesy of Goodhue County Historical Society



Typical Goodhue County clay pit mining operation, 1880's, Picture courtesy of Goodhue County Historical Society

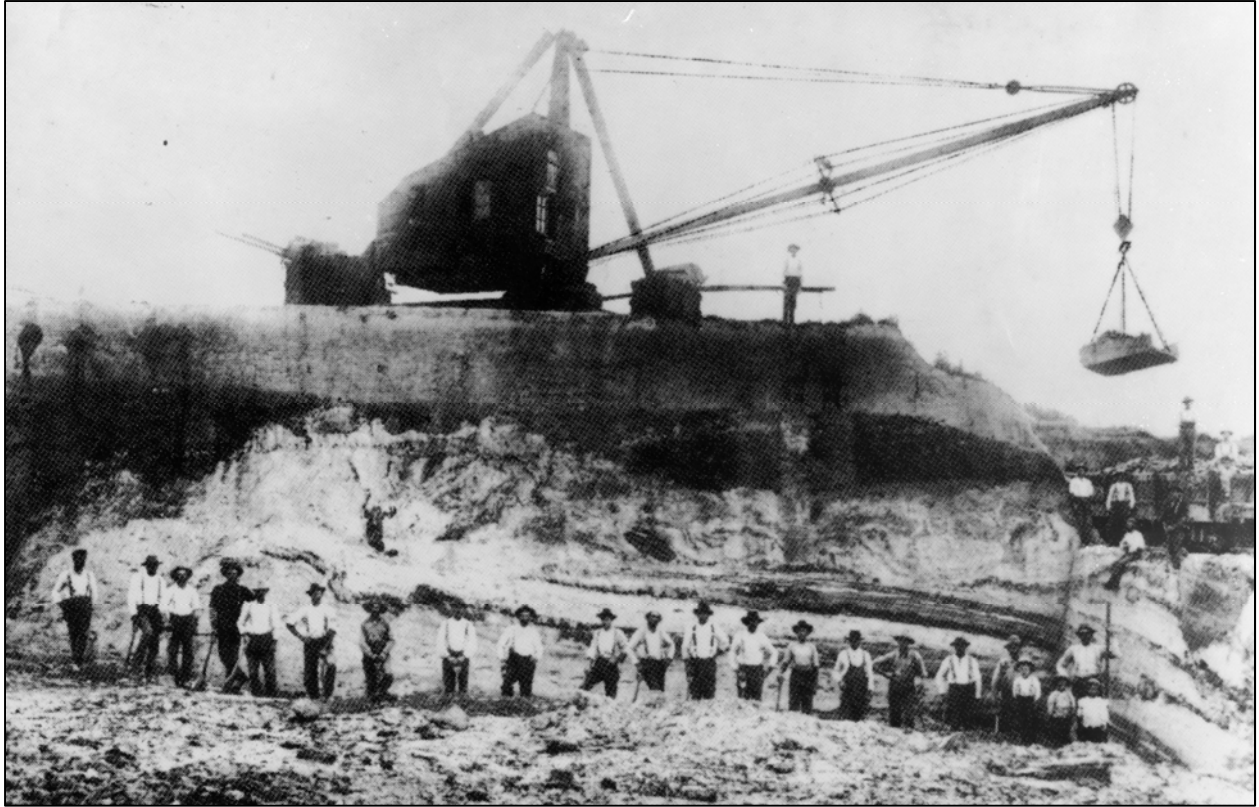

Typical Goodhue County clay pit mining operation, 1880's, Picture courtesy of Goodhue County Historical Society



20 gallon Red Wing salt glazed stoneware.



6" Red Wing artware bud vase.

Pictures courtesy of Red Wing Collectors Society