



Burley (Ghost Town)

LOCATION: 32000 block County 1 Boulevard, Featherstone Township, Minnesota

STATUS: Public

TYPE: Historic, District

HISTORY: Burley community started with a post office on the Red Wing to Cannon Falls stage line. A tavern, houses and a brick schoolhouse contributed to the short-lived community. The rural school was one of the first schools in the county to have free textbooks and an extensive library.

OTHER RESOURCES:

[Meyer, Roy W., *The Ghost Towns & Discontinued Post Offices of Goodhue County*, The Goodhue County Historical Society Press, Red Wing, MN, 2003](#)

PROPERTY PICTURES:

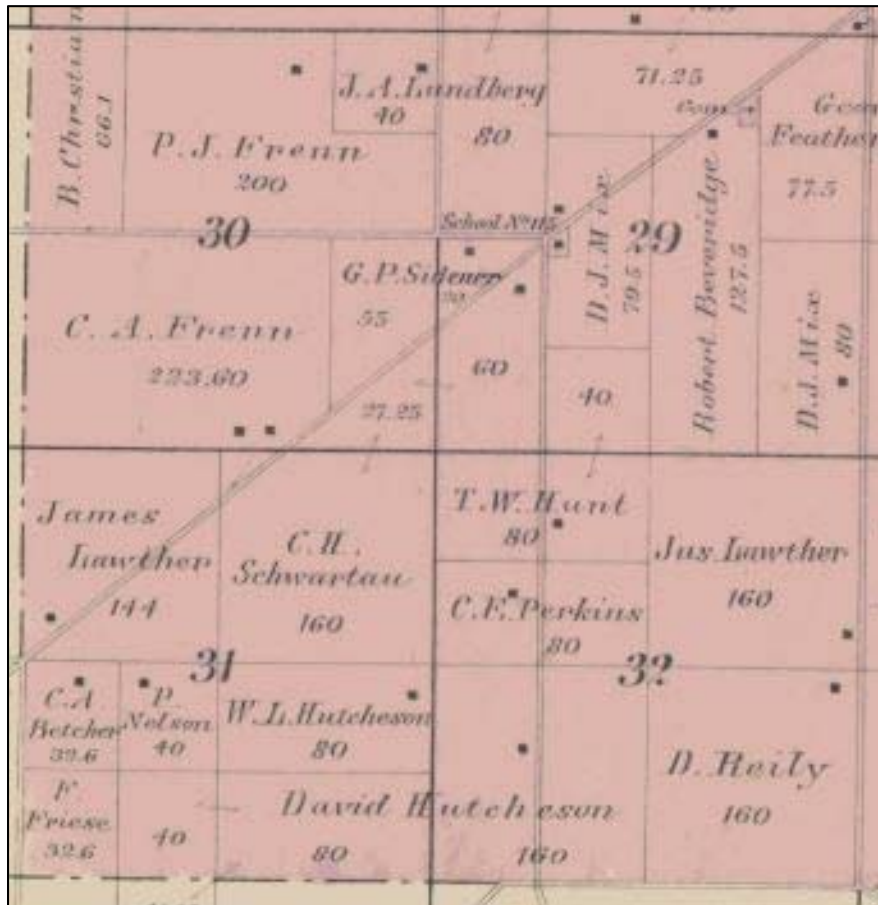

1894 Goodhue County Plat Book, Featherstone Township, Sections 29 – 32



Rural schoolhouse #115, Featherstone Prairie School. Picture courtesy of Goodhue County Historical Society