

CERTIFICATE OF LOCATION OF GOVERNMENT CORNER

NORTHEAST Corner of Section 36, Township 110, Range 16, 5TH P.M.

STATE OF MINNESOTA, County of GOODHUE.

At the corner location shown on the sketch

☒ ON 6/2/99 found GOODHUE COUNTY ALUMINUM MONUMENT AT

A DEPTH OF 1.2 FEET.

☒ left monument as found, ☐ lowered monument, ☐ removed monument (explain)

☐ ON _____ placed a _____

SKETCH OF REFERENCE TIES

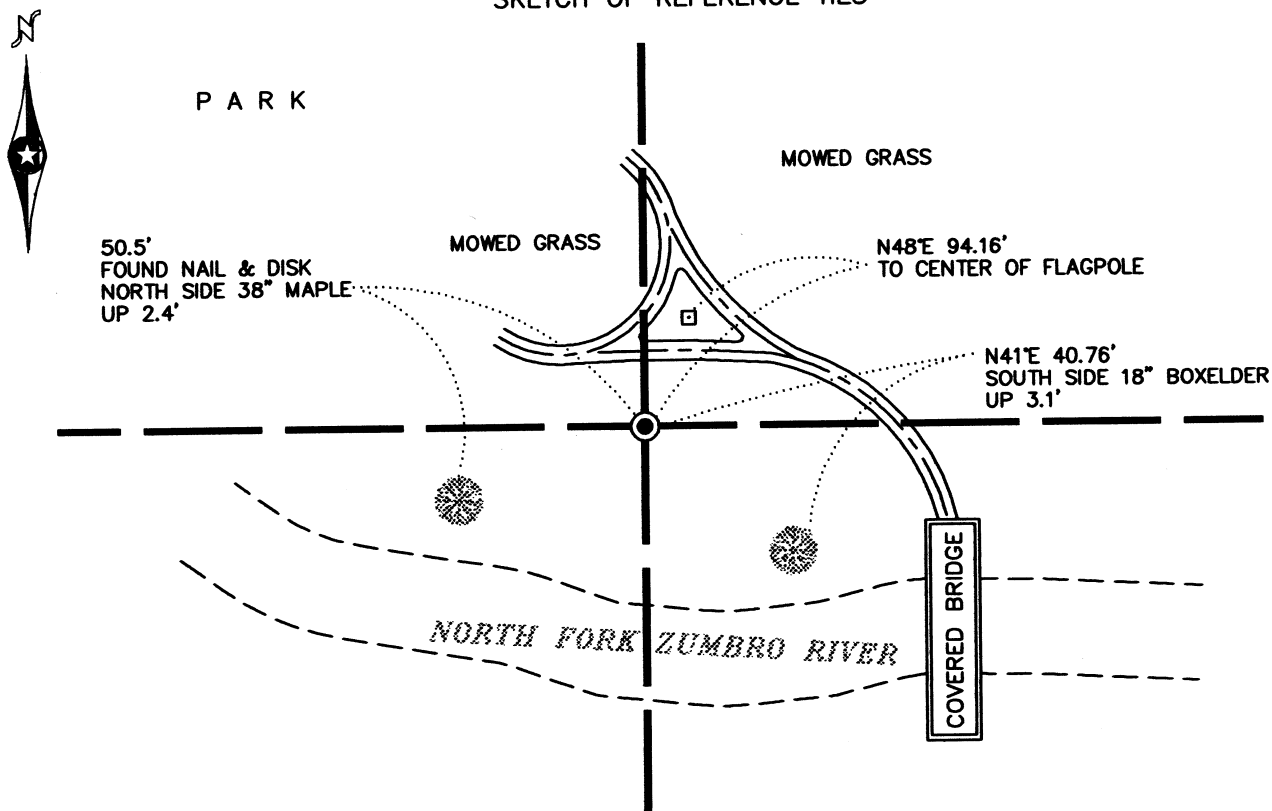

Statement of evidence relative to this corner is on back of page.

I hereby certify that this document and the data contained herein was prepared by me or under my direct supervision.

Dennis J. Robinson
SIGNATURE

11/23/04
DATE

Registration No. 19096

☐ Land surveyor, ☐ Professional Engineer
☒ Deputy County Surveyor, ☐ County Engineer

OFFICE OF THE COUNTY RECORDER

County of GOODHUE.

I hereby certify that this document was filed in the Co. Recorders office at _____ .M. on the _____ day of _____ A.D., 20

County Recorder _____

By _____, Deputy

DOCUMENT NO. _____