

MINNESOTA DEPARTMENT OF TRANSPORTATION RIGHT OF WAY PLAT NO. 20-55*

CONTROL SECTION NO. 2001 (14=7) 902
CONTROL SECTION NO. 2001 (14=7) 903
IN THE SOUTH HALF OF THE NORTHEAST QUARTER OF SECTION 31, T.107N., R.17W.,
IN THE NORTHWEST QUARTER OF THE NORTHEAST QUARTER OF SECTION 31, T.107N., R.17W.,
IN THE NORTHEAST QUARTER OF THE SOUTHWEST QUARTER OF SECTION 31, T.107N., R.17W.,
IN THE SOUTH HALF OF THE NORTHWEST QUARTER OF SECTION 32, T.107N., R.17W.,
IN THE NORTH HALF OF THE SOUTHWEST QUARTER OF SECTION 32, T.107N., R.17W.,
DODGE COUNTY, MINNESOTA

THE COMMISSIONER OF TRANSPORTATION IS HEREBY DESIGNATING THE DEFINITE LOCATION OF TRUNK HIGHWAY NO. 14 FROM 165TH AVENUE TO 1 MILE EAST IN WASIOJA TOWNSHIP,

as shown on this plat prepared by the State of Minnesota Department of Transportation is hereby certified as the official plat of that portion of said T.14 within the designated portion of Sections 31 & 32 and the Commissioner's Order therefor, pursuant to Minnesota Statutes, Section 160.085, Section 160.14 subd. 1, Section 161.16 subd. 2, and Section 161.18.

It is further ordered that it is necessary to acquire all trees, shrubs, grass and herbage within the right of way of said Trunk Highway, and to keep and have the exclusive control of the same.

Commissioner's Order No.	Location	Nature of Interest
98226	PLAT 20-55	Definite location, width, access, permanent drainage easement, and temporary easement.

Certified by
Margaret Anderson Kellner
Commissioner of Transportation

Peter W. Jenkins 20 Sep 19
Peter W. Jenkins
Assistant Director, Office of Land Management

I hereby certify that this plat was prepared by me or under my direct supervision and that I am a duly Licensed Land Surveyor under the Laws of the State of Minnesota; that all measurements are correctly shown on this plat; that all monuments have been correctly placed as shown on this plat; that Certificates of Location for the monumented Public Land Survey corners as shown on this plat are on file in the County Recorder's Office (if required under Minnesota Statutes, Section 160.15) and/or the County Surveyor's Office.

Certified by *Joshua J. DeLeon* 53071 9/24/2019
Joshua J. DeLeon
MnDOT District Office License No. Date

I hereby certify that this plat was surveyed by me or under my direct supervision and that I am a duly Licensed Land Surveyor under the Laws of the State of Minnesota; that all measurements are correctly shown on this plat; that all monuments have been correctly placed as shown on this plat; that Certificates of Location for the monumented Public Land Survey corners as shown on this plat are on file in the County Recorder's Office (if required under Minnesota Statutes, Section 160.15) and/or the County Surveyor's Office.

Certified by *Jordan B. Kurth* 48717 Sept. 25, 2019
Jordan B. Kurth
MnDOT District 6 Office License No. Date

5/8" PIN WITH A 3-1/4" ALUMINUM DODGE COUNTY CAP AT QUARTER CORNER

SURVEY STANDARDS

- The plat values, azimuths, and distances are based on the County coordinate system.
- The boundary monuments shown on this plat have been field checked for location. The standard deviation for the monument position is 0.10 feet.
- The county coordinates shown on one monument are based on ties to the National Spatial Reference System.
- For details of this survey contact the Surveying Section at the Minnesota Department of Transportation.

Rochester
Name of District

PERMANENT DRAINAGE EASEMENT				
FROM	TO	DISTANCE (FT)	AZIMUTH	
B1	B15	C 219.11	340°19'49"	
A 228.38	R	230.00	DEL 56°53'32" LT	
B15	B16	C 250.81	339°33'33"	
A 260.83	R	270.00	DEL 55°20'59" RT	
B16	B17	186.38	7°14'03"	
B17	B18	40.00	97°28'40"	
B18	B19	186.21	187°14'03"	
B19	B20	C 213.65	159°33'33"	
A 222.19	R	230.00	DEL 55°20'59" LT	
B20	B2	C 260.84	160°46'04"	
A 272.22	R	270.00	DEL 57°46'01" RT	

*** ON RAILROAD RIGHT OF WAY

SQUARE PIPE WITH CAST IRON CAP AT SECTION CORNER

*AMENDMENT TO:
MINNESOTA DEPARTMENT OF TRANSPORTATION
RIGHT OF WAY PLAT NO. 20-52
PARCEL 59

DODGE COUNTY COORDINATES
X=497771.402
Y=171495.259
NAD 83(1996 ADJ.)

5/8" PIN WITH A 3-1/4" ALUMINUM DODGE COUNTY CAP AT QUARTER CORNER

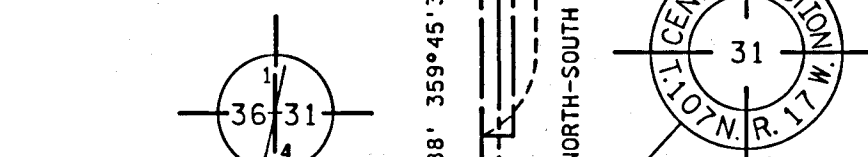

17' EXISTING SLOPE EASEMENT DOC. NO. 98775
17' EXISTING SLOPE EASEMENT DOC. NO. 98752

17' EXISTING SLOPE EASEMENT DOC. NOS. 98728, 98751, 98756, 98776

17' EXISTING SLOPE EASEMENT DOC. NO. 98728

2" SQUARE BY 30" PIPE WITH CAST IRON CAP AT WITNESS CORNER

NO MONUMENT AT QUARTER CORNER (COMPUTED POSITION)

RIGHT OF WAY IN SECTION 31 C.S. 2001 (14=7) 903

PARCEL	OWNER	LOCATION	NEW T.H. R/W ACRES MORE OR LESS	PERMANENT DRAINAGE EASEMENT ACRES MORE OR LESS	TEMPORARY EASEMENT ACRES MORE OR LESS	EXPIRES	PERMANENT R/W INTEREST	FEE
59	LYNN M. CHARLS	SE1/4 NE1/4	19.45					

PLAT BOUNDARY DATA				
FROM	TO	DISTANCE (FT)	AZIMUTH	
B1	B2	40.18	104°39'57"	
B2	B3	736.89	104°39'57"	
B3	B4	C 664.15	107°55'53"	
A 664.51	R	5829.58	DEL 6°31'52" RT	
B4	B5	586.39	90°07'15"	
B5	B32*	323.99	359°57'09"	
B32*	B31*	93.70	89°57'09"	
B31	B2	492.74	84°58'16"	
B2	B6	690.42	156°53'27"	
B6	B7	C 726.93	115°12'15"	
A 735.70	R	1372.39	DEL 30°42'53" LT	
B7	B4*	825.03	89°49'23"	
B4*	B5*	90.98	179°49'23"	
B5*	B6*	69.02	179°49'23"	
B6*	B7*	1175.00	269°49'23"	
B7*	B8*	1192.28	139°04'33"	
B8*	B17*	325.00	223°02'28"	
B17*	B8	421.10	313°35'50"	
B8	B9	556.25	310°03'26"	
B9	B10	C 832.96	305°48'53"	
A 833.72	R	5629.58	DEL 8°29'07" LT	
B10	B20*	315.92	269°49'23"	
B20*	B21*	312.10	269°49'23"	
B21*	B22*	80.50	359°49'23"	
B22*	B21	1006.14	270°08'58"	
B21	B22	598.44	359°51'21"	
B22	B5213	1365.37	284°39'57"	
B5213	B5214	293.89	359°45'32"	
B5214	B1	694.08	104°39'57"	

*** ON PLAT 20-36
*** ON PROPERTY LINE

SQUARE PIPE WITH CAST IRON CAP AT SECTION CORNER

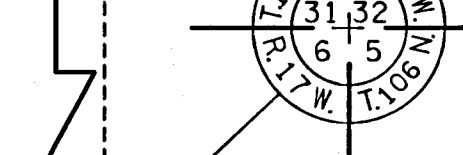

CONVENTIONAL SYMBOLS

Section Line	_____	R/W Parcel Number	_____
Quarter Line	_____	Access Control	_____
Sixteenth Line	_____	Access Opening	_____
Property Line	_____	Cast Iron Monument	_____
R/W Boundary	_____	2in. x 2in. D.O.T. Iron Tube with Cap	_____
Existing D.O.T. R/W Line	_____	3/4" D.O.T. Iron Pin	_____
And Other Road R/W	_____	Other Iron Monument	_____
Railroad R/W	_____	Concrete or Stone Monument	_____
Private Easement	_____	R/W Boundary Corner	_____
Temporary Easement	_____		
Building Removal Easement	_____		

DISTANCES SHOWN TO FEET (66, 80 ETC.) ARE EXACT VALUES.

AZIMUTH ORIENTATION AND GRID CONVERSION
Plat azimuths are oriented to the County Coordinate System with 0 degrees 0 minutes 0 seconds being "GRID NORTH". Plat distances are ground lengths.



DOC. NO. 230467

OFFICE OF COUNTY RECORDER
DODGE COUNTY, MINNESOTA
I HEREBY CERTIFY THAT THIS PLAT
HAS BEEN FILED IN THIS OFFICE
ON 10-2-2019 AT 3:30 PM
IN CAB B of Plats NO. 178
COUNTY RECORDER

PLAT NO. 20-55*
C.S. 2001 (14=7) 902
C.S. 2001 (14=7) 903