

SHOPKO ADDITION

KNOW ALL PERSONS BY THESE PRESENTS: That KTJ 234 LLC, a limited liability company, fee owner, of the following described property situated in the County of Dodge, State of Minnesota, to wit:

Lots 5 through 16, inclusive, Block 27, Kasson, Dodge County, Minnesota and the west half of vacated 1st Avenue Southwest (Formerly known as Aitkin Street) adjacent and adjoining thereto

And

Lots 5 through 14, inclusive, and Lot 16, all in Block 26, Kasson, Dodge County, Minnesota and the east half of vacated 1st Avenue Southwest (Formerly known as Aitkin Street) adjacent and adjoining thereto

Except, the east 17.00 feet of said Block 26, Kasson

Also except that part of said Block 26, Kasson, shown as Parcel 10 on STATE HIGHWAY RIGHT OF WAY PLAT NO. 20-3.

Have caused the same to be surveyed and platted as SHOPKO ADDITION, and do hereby grant to the City of Kasson the easements for drainage and utility purposes as shown on this plat.

In witness whereof said KTJ 234 LLC, a limited liability company, has caused these presents to be signed by its proper officer this 19th day of June, 2014.

KTJ 234 LLC, a limited liability company

SIGNED: [Signature]

By: Daniel Smith, as Vice President

STATE OF MINNESOTA

COUNTY OF Hennepin

The foregoing instrument was acknowledged before me this 19th day of June, 2014, by Daniel Smith, as Vice President of KTJ 234 LLC, a limited liability company, on behalf of the company.

[Signature]
Notary Public, Hennepin County, Minnesota
My Commission Expires January 1, 2017

[Signature]
Notary Printed Name

I, Marcus F. Hampton do hereby certify that this plat was prepared by me or under my direct supervision; that I am a duly Licensed Land Surveyor in the State of Minnesota; that this plat is a correct representation of the boundary survey; that all mathematical data and labels are correctly designated on this plat; that all monuments depicted on this plat have been, or will be correctly set within one year; that all water boundaries and wet lands, as defined in Minnesota Statutes, Section 505.01, Subd. 3, as of the date of this certificate are shown and labeled on this Plat; and all public ways are shown and labeled on this plat.

Dated this 19 day of June, 2014.

[Signature]
Marcus F. Hampton, Licensed Land Surveyor,
Minnesota License No. 47481

STATE OF MINNESOTA

COUNTY OF Hennepin

The foregoing instrument was acknowledged before me this 19 day of June, 2014, by Marcus F. Hampton, a Licensed Land Surveyor.

[Signature]
Notary Public, Hennepin County, Minnesota
My Commission Expires Jan 31, 2016

Jessika C. Ball
Notary Printed Name

KASSON, MINNESOTA

This plat of SHOPKO ADDITION was approved and accepted by the City Council of Kasson, Minnesota, at a regular meeting thereof held this 19th day of June, 2014. If applicable, the written comments and recommendations of the Commissioner of Transportation and the County Highway Engineer have been received by the City or the prescribed 30-day period has elapsed without receipt of such comments and recommendations, as provided by Minnesota Statutes, Section 505.03, Subdivision 2.

City Council, Kasson, Minnesota

By: [Signature] Mayor By: [Signature] Clerk

- DENOTES 1/2 INCH BY 14 INCH IRON MONUMENT SET AND MARKED BY LICENSE NO. 47481.
 - DENOTES 1/2 INCH IRON MONUMENT FOUND AND MARKED BY REGISTRATION NO. 14888 UNLESS OTHERWISE SHOWN.
 - (XXX.XX) DENOTES DIMENSION PER UNDERLYING PLAT
- BENCHMARK ELEVATION=1236.63 FEET (NGVD-29)
SANITARY MANHOLE LOCATED IN THE INTERSECTION OF MANTORVILLE AVENUE SOUTH AND 4TH STREET.
- THE WEST LINE OF BLOCK 27, ORIGINAL PLAT OF CITY OF KASSON, IS ASSUMED TO HAVE A BEARING OF SOUTH 00 DEGREES 23 MINUTES 41 SECONDS WEST.

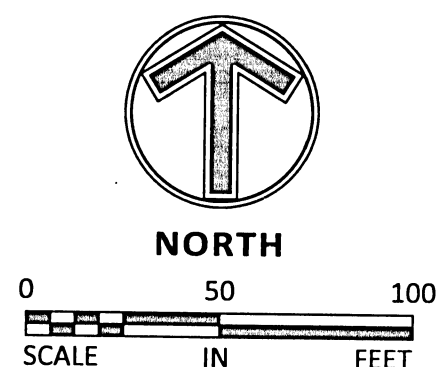

VICINITY MAP

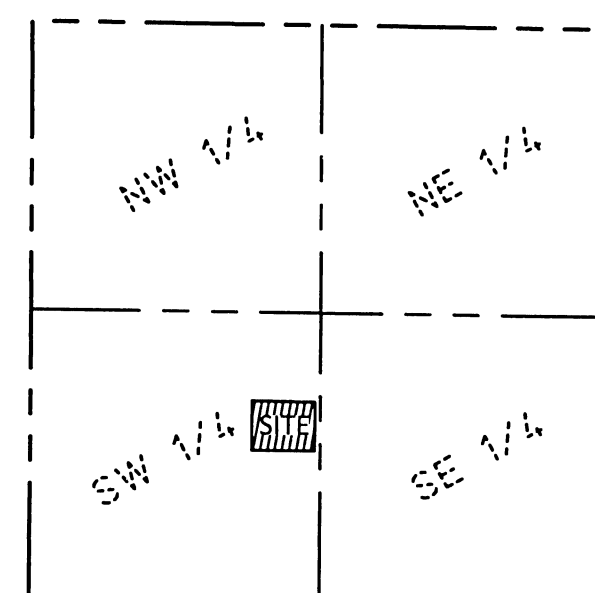

SECTION 33, TOWNSHIP 107N,
RANGE 16W, DODGE COUNTY,
MINNESOTA



TAXPAYERS SERVICES DEPARTMENT, Dodge County, Minnesota

I hereby certify that the taxes payable in the year 2014 on the land described have been paid, there are no delinquent taxes and transfer has been entered this 19th day of June, 2014.

[Signature], County Auditor

By: _____, Deputy

COUNTY SURVEYOR, Dodge County, Minnesota

Pursuant to Minnesota Statutes Section 389.09, this plat has been approved this 2nd day of July, 2014.

[Signature]
Lisa M. Hänni, L.S., County Surveyor

COUNTY RECORDER, Dodge County, Minnesota

Document Number: 2014-491

I hereby certify that the within plat of SHOPKO ADDITION was recorded in this office this 11th day of July, 2014, at 3:00 o'clock P.M., and was duly recorded in Book 150 of Plats, page 150.

[Signature], County Recorder

By: _____, Deputy

