

CONDOMINIUM NUMBER 3 THE POTTERY CONDOMINIUM THIRD AMENDMENT TO CONDOMINIUM PLAT

This Amended Condominium Plat has been recorded as part of the Amendment to Declaration and Condominium Plat filed as Document Number 31841 on the 16th day of FEBRUARY 1988, Goodhue County Recorder.

Note: The original Condominium Plat and Declaration were filed on December 22, 1982 as document number 283309, Goodhue County Recorders Office.

Benchmark: Top nut fire hydrant on north side of Main Street opposite west end of 4 (four) story brick building. Elevation 708.41 feet. (City Engineering Department datum)

THIRD FLOOR

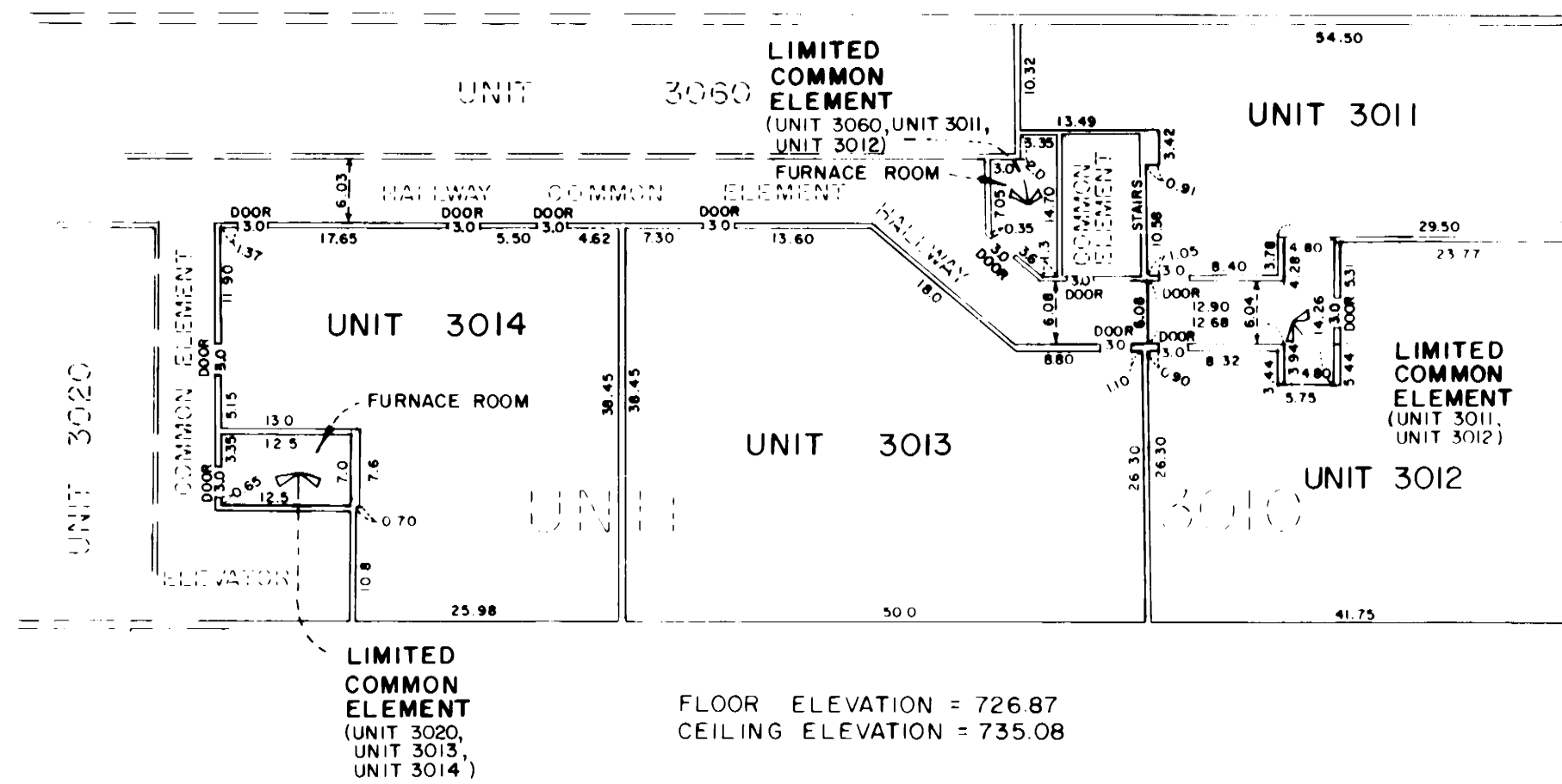

The undersigned being first duly sworn under oath, certifies and deposes that this Amended Condominium Plat of Unit 3010, CONDOMINIUM NO. 3, THE POTTERY CONDOMINIUM, fully and accurately depicts all information required by Minnesota Statutes Sections 515A. 2-110 and 515A. 2-115.

David A. Johnson
David A. Johnson, Registered Land Surveyor
Minn. Registration No. 12788

NOTARY:
State of Minnesota)
County of Goodhue) ss.

The foregoing instrument was acknowledged before me this 4th day of February, 1988 by David A. Johnson, a registered professional land surveyor.

Debra S. Scofield
Notary Public

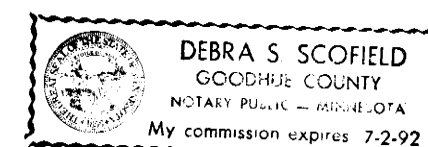

==== Denotes existing wall as the unit vertical plane boundary

JOHNSON & SCOFIELD INC.
LAND SURVEYORS
1203 MAIN STREET · RED WING · MN 55066 612 · 388 · 1558
Wabasha County Surveyors
Wabasha County Courthouse · Wabasha · MN 55981
612 · 565 · 3244