

CANNON VALLEY TRAIL PLAT NO. 1

VICINITY MAP SEC. 8, T112N, R17W

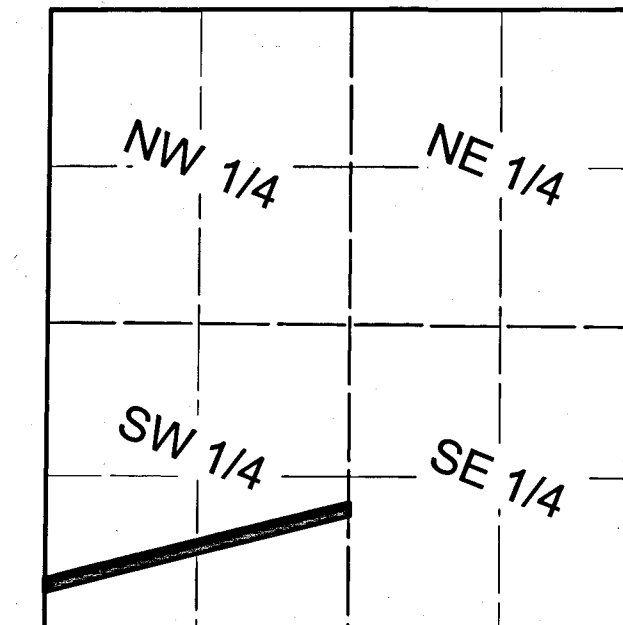

NOT TO SCALE

I hereby certify that this survey, plan, or report was prepared by me or under my direct supervision and that I am a duly Licensed Land Surveyor under the laws of the State of Minnesota.

Dale G. Lempke Signature *Dale G. Lempke*
 MN License No. 49773 Date 1-13-2021

The County of Goodhue, a body politic and corporate under the laws of the State of Minnesota, in conjunction with the Cannon Valley Trail Joint Powers Board, have mapped the Cannon Valley Trail in order to give supplemental information as to the location of the transportation corridor, pursuant to Minnesota Statutes 507.1792, as it transgresses over, under, and across the following tracts of land:
 Section 8, Township 112 North, Range 17 West, Goodhue County, MN:
 Southwest Quarter

Approved by the County Board of Commissioners at their November 17, 2020 County Board meeting.
 Chair: *[Signature]* Administrator: *[Signature]*

Approved by the Cannon Valley Trail Joint Powers Board at their November 24, 2020, Board meeting.
 Chair: *[Signature]* Administrator: *[Signature]*

I hereby certify that this survey, plan, or report was reviewed and approved according to Minnesota Statutes 507.1792 on this 1st day of March, 2021.

[Signature]
 Lisa M. Hanni, LS 23048
 Goodhue County Surveyor

Document Number: 672801
 I hereby certify that this instrument was filed in the office of the County Recorder for record this day of March, 2021, at 8:22 o'clock a.m. and was duly recorded in the Goodhue County records as file number 2nd

[Signature]
 Lisa M. Hanni, LS 23048
 Goodhue County Recorder

Existing Legal Description of Record (Document No. 299420):

A strip of land 100 feet in width extending over and across the South Half of the Southwest Quarter of Section 8, Township 112 North, Range 17 West, Goodhue County, Minnesota; said strip of land being 50 feet in width on each side of the center line of the main track (now removed) of the Minnesota Central Railroad Company (later the Wisconsin, Minnesota and Pacific Railroad Company, the Chicago Great Western Railway Company, and the Chicago and North Western Transportation Company), as said main track center line was originally located and established over and across said Section 8.

Parcel 1	6.21 AC	Fee Interest
----------	---------	--------------

SE 1/4 - SW 1/4

CANNON VALLEY TRAIL PLAT NO. 2

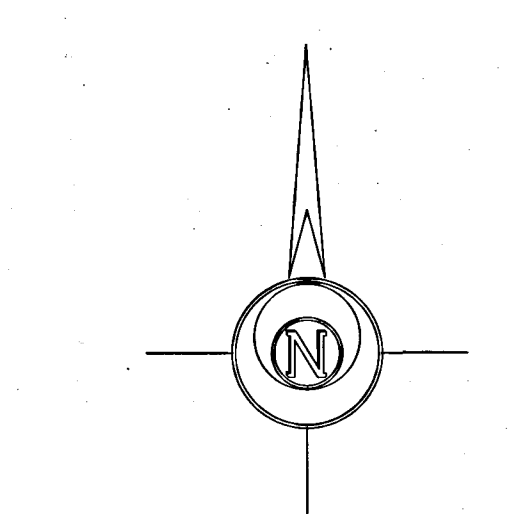

Azimuths are based on the 1996 HARN Adjustment of NAD 1983 Goodhue County Coordinate System and are referenced clockwise from North with North being 00 degrees 00 minutes 00 seconds.

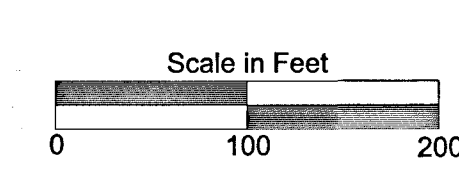

LEGEND	
	Plat Boundary
	Section Line
	Quarter Line
	Sixteenth Line
	CVT Centerline
	Township Road ROW
	PLS Monument
	Set Monument*
	Found Monument

* Monuments Set are 5/8" x 18" Rebar with 2" Aluminum Cap marked "CANNON VALLEY TRAIL SURVEY MARKER - LS 49773"

west line of the SW 1/4 Section 8, T112N, R17W

east line of the SW 1/4 Section 8, T112N, R17W

CANNON RIVER

CANNON VALLEY TRAIL

SW 1/4 - SW 1/4

HARDWOOD WAY

359°12'58" 328.63

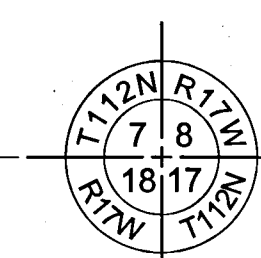

Goodhue County Monument
 3-inch Aluminum Cap on Rebar

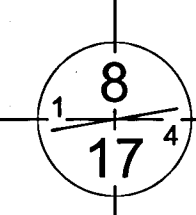

Goodhue County
 Cast Iron Monument

359°12'58" 102.70

50
50

50
50

76°02'32" 2708.00

256°02'32" 2706.84

179°50'42" 1001.60

179°50'42" 102.97