

# CANNON VALLEY TRAIL PLAT NO. 16

## VICINITY MAP SEC. 6, T112N, R16W

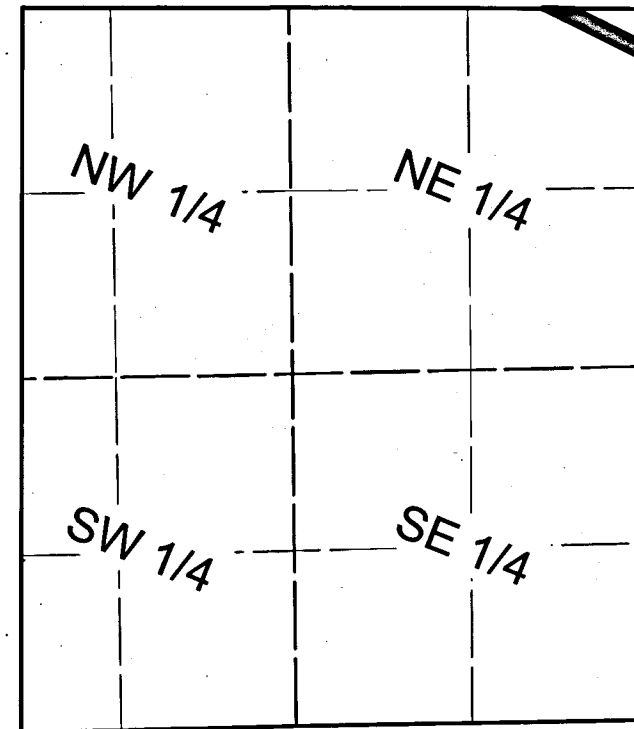

NOT TO SCALE

I hereby certify that this survey, plan, or report was prepared by me or under my direct supervision and that I am a duly Licensed Land Surveyor under the laws of the State of Minnesota.

Dale G. Lempke Signature *Dale G. Lempke*  
MN License No. 49773 Date 1-13-2021

The County of Goodhue, a body politic and corporate under the laws of the State of Minnesota, in conjunction with the Cannon Valley Trail Joint Powers Board, have mapped the Cannon Valley Trail in order to give supplemental information as to the location of the transportation corridor, pursuant to Minnesota Statutes 507.1792, as it transgresses over, under, and across the following tracts of land:  
Section 6, Township 112 North, Range 16 West, Goodhue County, MN:  
Northeast Quarter of the Northeast Quarter

Approved by the County Board of Commissioners at their November 17, 2020 County Board meeting.

Chair: *[Signature]* Administrator: *[Signature]*

Approved by the Cannon Valley Trail Joint Powers Board at their November 24, 2020 Board meeting.

Chair: *[Signature]* Administrator: *[Signature]*

I hereby certify that this survey, plan, or report was reviewed and approved according to Minnesota Statutes 507.1792 on this 1<sup>st</sup> day of March, 2021.

*[Signature]*  
Lisa M. Hanni, LS 23048  
Goodhue County Surveyor

Document Number: 602977

I hereby certify that this instrument was filed in the office of the County Recorder for record this 8<sup>th</sup> day of March, 2021, at 8:20 o'clock a. m., and was duly recorded in the Goodhue County records as file number         

*[Signature]*  
Lisa M. Hanni, LS 23048  
Goodhue County Recorder

NW 1/4 - NE 1/4

### Existing Legal Description of Record (Document No. 299420):

A strip of land 100 feet in width extending over and across the Northeast Quarter of the Northeast Quarter of Section 6, Township 112 North, Range 16 West, Goodhue County, Minnesota; said strip of land being 50 feet in width on each side of the center line of the main track (now removed) of the Minnesota Central Railroad Company (later the Wisconsin, Minnesota and Pacific Railroad Company, the Chicago Great Western Railway Company, and the Chicago and North Western Transportation Company), as said main track center line was originally located and established over and across said Section 6.

Parcel 1	1.68 AC	Fee Interest
----------	---------	--------------

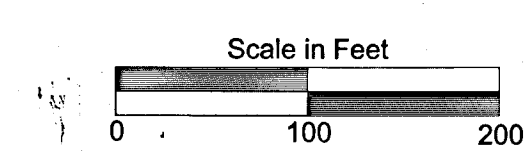

SE Corner of NE 1/4 Sec. 6 T112N R16W  
3/4" x 24" Iron Pipe

$\Delta=03^{\circ}44'28''$  R=1960.08  
L=121.96 CH=121.94  
CH AZ=234^{\circ}25'54''

$\Delta=02^{\circ}25'10''$  R=1860.08  
L=78.55 CH=78.54  
CH AZ=115^{\circ}05'32''

LEGEND	
	Plat Boundary
	Section Line
	Quarter Line
	Sixteenth Line
	CVT Centerline
	Township Road ROW
	PLS Monument
	Set Monument
	Found Monument

Azimuths are based on the 1996 HARN Adjustment of NAD 1983 Goodhue County Coordinate System and are referenced clockwise from North with North being 00 degrees 00 minutes 00 seconds.

\* Monuments Set are 5/8" x 18" Rebar with 2" Aluminum Cap marked "CANNON VALLEY TRAIL SURVEY MARKER - LS 49773"

SAND RD

SUNSET TRAIL

SUNSET TRAIL

CANNON VALLEY TRAIL  
PLAT NO. 15

NE 1/4 - NE 1/4

SE 1/4 - SE 1/4  
SEC 31 T113N R16W

CANNON RIVER

SEC. 5  
T112N R16W

CANNON VALLEY TRAIL  
PLAT NO. 17

NE Corner Sec. 6 T112N R16W  
0.33' North of Sandstone  
Monument at Closing Corner

T113N R16W  
31 32  
6 5  
5  
Sandstone  
Monument

