

26  
35

Goodhue County Monument

# CANNON VALLEY TRAIL PLAT NO. 28

VICINITY MAP  
SEC. 35 T113N R16W

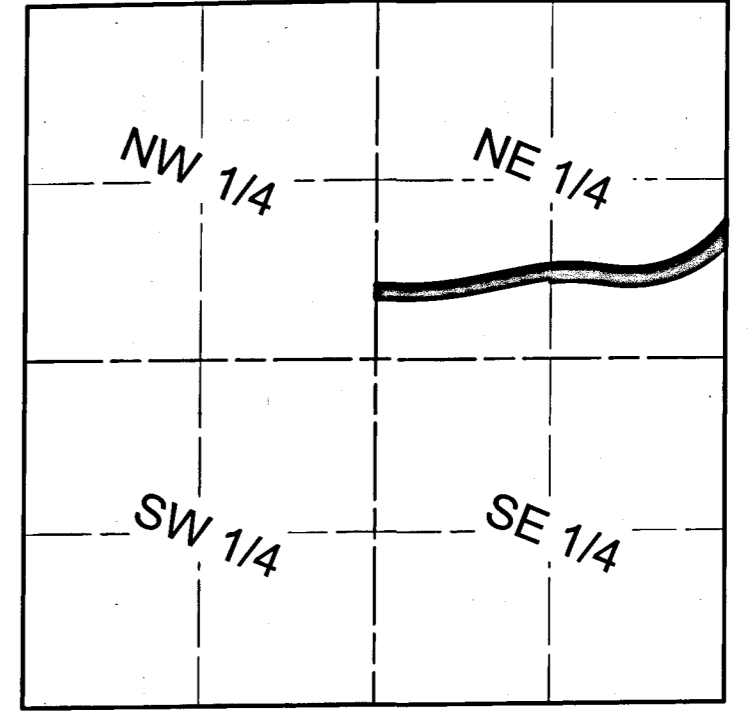

NOT TO SCALE

I hereby certify that this survey, plan, or report was prepared by me or under my direct supervision and that I am a duly Licensed Land Surveyor under the laws of the State of Minnesota.

Dale G. Lempke Signature: *Dale G. Lempke*  
MN License No. 49773 Date: 1-13-2021

The County of Goodhue, a body politic and corporate under the laws of the State of Minnesota, in conjunction with the Cannon Valley Trail Joint Powers Board, have mapped the Cannon Valley Trail in order to give supplemental information as to the location of the transportation corridor, pursuant to Minnesota Statutes 507.1792, as it transgresses over, under, and across the following tracts of land: Section 35, Township 113 North, Range 16 West, Goodhue County, MN: South Half of the Northeast Quarter

Approved by the County Board of Commissioners at their November 17, 2020 County Board meeting.

Chair: *Bud Asher* Administrator: *Scott Olson*

Approved by the Cannon Valley Trail Joint Powers Board at their November 24, 2020 Board meeting.

Chair: *Samuel J. Boudry* Administrator: *AS R*

I hereby certify that this survey, plan, or report was reviewed and approved according to Minnesota Statutes 507.1792 on this 1st day of March, 2021.

*Lisa M. Hanni*  
Lisa M. Hanni, LS 23048  
Goodhue County Surveyor

Document Number: 1073057  
I hereby certify that this instrument was filed in the office of the County Recorder for record this day of March, 2021, at 9:13 o'clock a.m., and was duly recorded in the Goodhue County records as file number 945

*Lisa M. Hanni*  
Lisa M. Hanni, LS 23048  
Goodhue County Recorder

CANNON RIVER

BELLE CREEK

Parcel 1	7.05 AC	Fee Interest
----------	---------	--------------

Existing Legal Description of Record (Document No. 299420):

A strip of land 100 feet in width extending over and across the Southwest Quarter of the Northeast Quarter of Section 35, Township 113 North, Range 16 West, Goodhue County, Minnesota; said strip of land being 50 feet in width on each side of the center line of the main track of the Minnesota Central Railroad Company (later the Wisconsin, Minnesota and Pacific Railroad Company, the Chicago Great Western Railway Company, and the Chicago and North Western Transportation Company), as said main track center line was originally located and established over and across said Section 35.

Also, a strip of land 125 feet in width extending over and across the Southeast Quarter of the Northeast Quarter of Section 35, Township 113 North, Range 16 West, Goodhue County, Minnesota; said strip of land being 50 feet in width on the Northwestern and Northern side, and 75 feet in width on the Southeastern and Southern side of the center line of the main track of the Minnesota Central Railroad Company (later the Wisconsin, Minnesota and Pacific Railroad Company, the Chicago Great Western Railway Company, and the Chicago and North Western Transportation Company), as said main track center line was originally located and established over and across said Section 35.

SW1/4 - NE1/4

SE1/4 - NE1/4

$\Delta=17^{\circ}46'39''$  R=1482.69  
L=460.04 CH=458.20  
CH AZ= $87^{\circ}54'03''$

$\Delta=59^{\circ}43'23''$  R=905.37  
L=943.72 CH=901.58  
CH AZ= $66^{\circ}55'42''$

$\Delta=11^{\circ}37'50''$  R=2814.93  
L=571.41 CH=570.43  
CH AZ= $84^{\circ}49'39''$

$\Delta=51^{\circ}11'01''$  R=1030.37  
L=920.45 CH=890.15  
CH AZ= $251^{\circ}11'52''$

$\Delta=11^{\circ}37'50''$  R=2814.93  
L=591.71 CH=590.69  
CH AZ= $264^{\circ}49'39''$

$\Delta=0^{\circ}44'42''$  R=1382.89  
L=14.51 CH=14.48  
CH AZ= $261^{\circ}23'05''$

$\Delta=13^{\circ}09'22''$  R=1357.89  
L=311.75 CH=311.07  
CH AZ= $270^{\circ}12'42''$

$276^{\circ}47'23''$   
152.98

CANNON VALLEY TRAIL PLAT NO. 27

CANNON VALLEY TRAIL

LEGEND	
	Plat Boundary
	Section Line
	Quarter Line
	Sixteenth Line
	CVT Centerline
	PLS Monument
	Set Monument*
	Found Monument

\* Monuments Set are 5/8" x 18" Rebar with 2" Aluminum Cap marked "CANNON VALLEY TRAIL SURVEY MARKER - LS 49773"

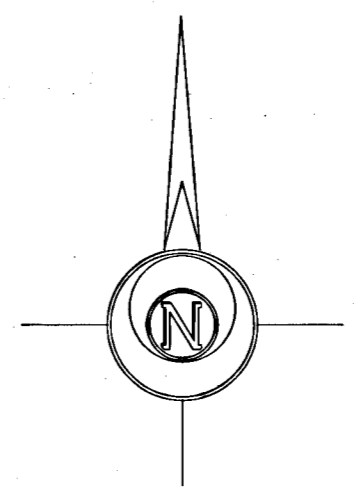
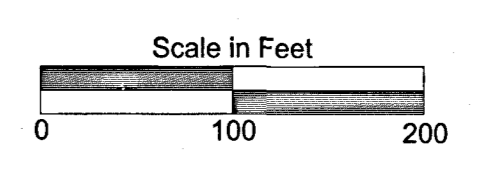

Azimuths are based on the 1996 HARN Adjustment of NAD 1983 Goodhue County Coordinate System and are referenced clockwise from North with North being 00 degrees 00 minutes 00 seconds.

Goodhue County Monument  
1 1/2" x 30" Iron Pipe with Brass Cap  
35/36