

GOODHUE COUNTY RIGHT OF WAY PLAT NO. 86

County Road No. 53

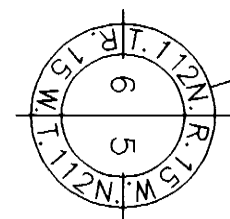

Goodhue County Monument

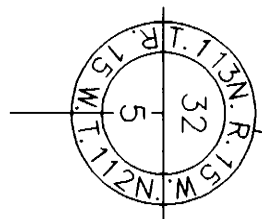

Goodhue County Monument

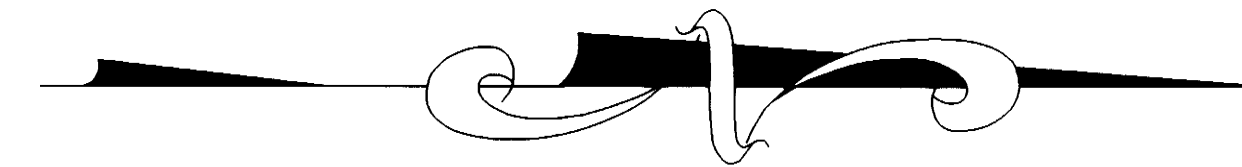
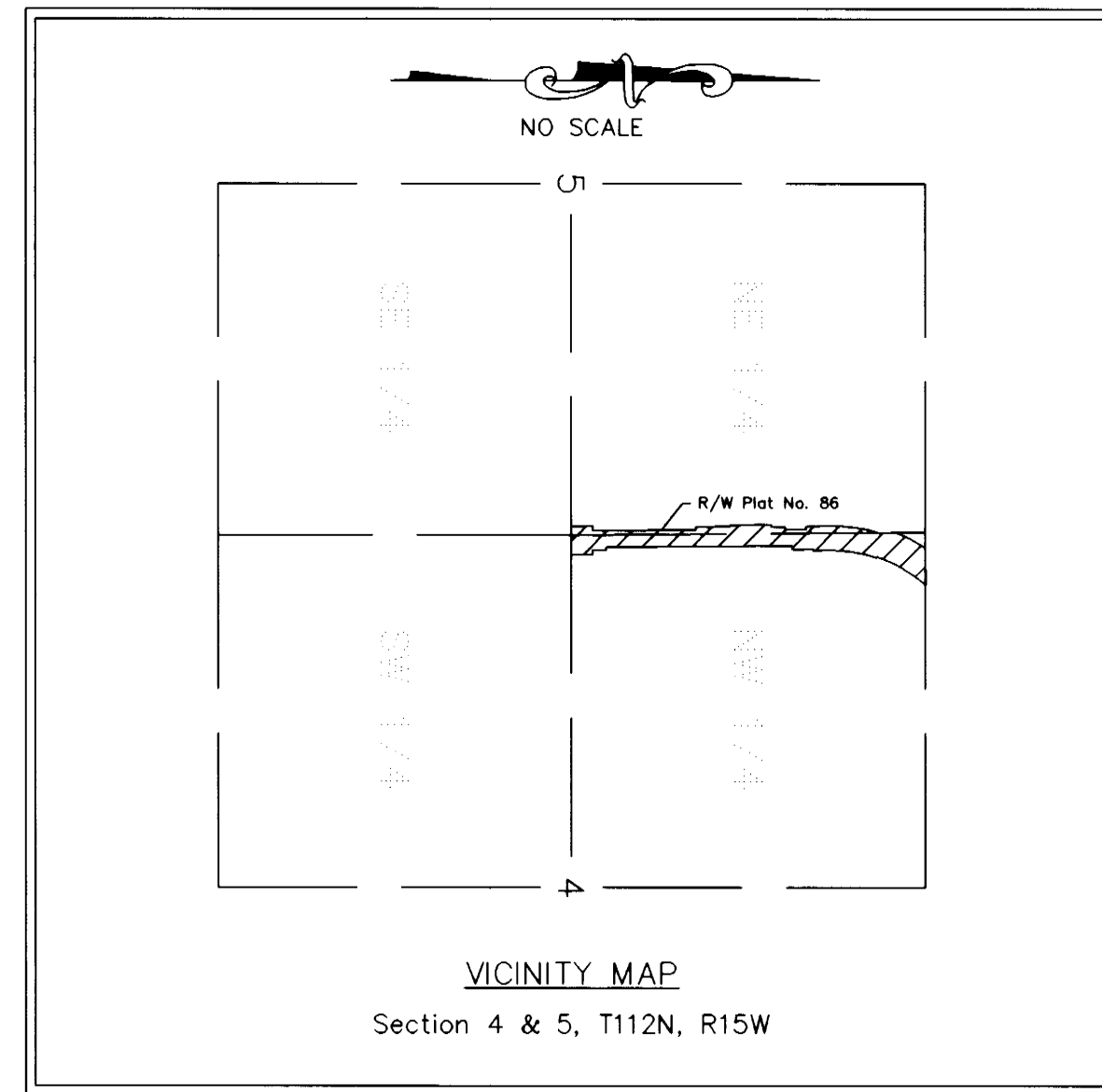

GRAPHIC SCALE

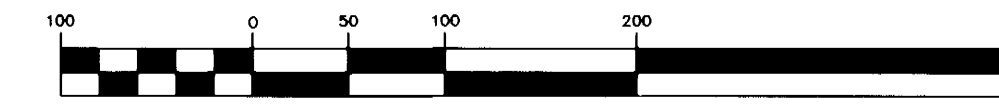

(IN FEET)
1 inch = 100 ft.

AZIMUTH ORIENTATION

This azimuth system is based on the N.A.D. 83 State Plane Coordinate System through the Goodhue County Coordinate System with North being 0 degrees 00 minutes 00 seconds and all azimuths referenced clockwise from North.

Goodhue County Monument

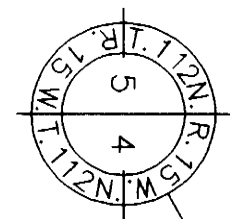

Goodhue County Monument

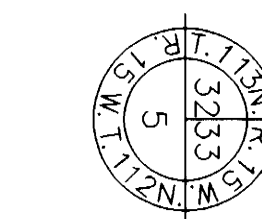

Goodhue County Monument

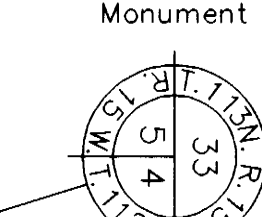

GOODHUE COUNTY R/W PLAT NO. 85

GOODHUE COUNTY R/W PLAT NO. 87

Goodhue County Monument

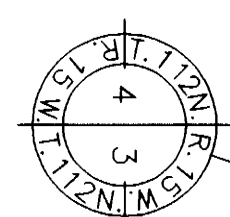

Goodhue County Monument

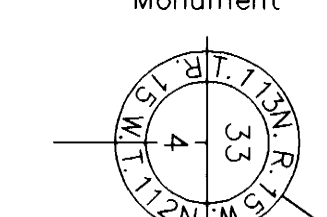

THE GOODHUE COUNTY BOARD OF COMMISSIONERS IS HEREBY DESIGNATING THE DEFINITE LOCATION OF COUNTY ROAD NO. 53 BETWEEN THE SOUTH LINE OF THE NORTHEAST QUARTER AND THE NORTH LINE OF THE NORTHEAST QUARTER OF SECTION 5, TOWNSHIP 112 NORTH, RANGE 15 WEST, GOODHUE COUNTY.

PORTION OF SAID HIGHWAY AS SHOWN ON THIS PLAT JOINTLY PREPARED BY THE COUNTY HIGHWAY DEPARTMENT AND THE COUNTY SURVEYOR OF GOODHUE COUNTY, IS HEREBY CERTIFIED AS THE OFFICIAL PLAT PURSUANT TO MINNESOTA STATUTES CHAPTER 160.085.

I hereby certify that the highway location and right of way is correctly designated on this plat.

Certified by Gregory J. Paulsen Registration No. 18484 Date 4/17/95
County Engineer

I hereby certify that this plat was prepared by me or under my direct supervision and that I am a duly Licensed Land Surveyor under the laws of the State of Minnesota, that this plat meets the requirements of Minnesota Statutes Chapter 160.085, that all measurements are correctly shown on this plat, and that the proposed right of way boundary lines are correctly designated on this plat.

Certified by Jeffrey J. Gurno License No. 13144 Date 4/17/95
County Surveyor

CONVENTIONAL SYMBOLS

- Section Line _____
- Quarter Line _____
- Sixteenth Line _____
- Property Line _____
- R/W Boundary _____
- Existing Road R/W _____
- R/W Parcel No. _____
- Other Road R/W _____

RIGHT OF WAY IN SECTION 4 AND 5, T112N, R15W

PARCEL	OWNER	LOCATION	EXIST. HIGHWAY R/W acres (more or less)	NEW HIGHWAY R/W acres (more or less) exclud. exist. R/W	PERMANENT R/W INTEREST
1	LOIS A. ECKBLAD	SE 1/4 OF THE NE 1/4 SEC. 5	0.07	1.23	FEE
2	HAROLD E. WILLIAMSON AND DONNA WILLIAMSON, HUSBAND AND WIFE, AS JOINT TENANTS	NE 1/4 OF THE NE 1/4 SEC. 5	0.24	0.68	FEE
3	LOIS A. ECKBLAD	NW 1/4 OF THE NW 1/4 SEC. 4	1.21	3.17	FEE
4	LOIS A. ECKBLAD TRUST	SW 1/4 OF THE NW 1/4 SEC. 4	1.83	0.99	FEE
5	BRUCE AUGUSTAVE ECKBLAD AND PRISCILLA ANN ECKBLAD, HUSBAND AND WIFE, AS JOINT TENANTS	SW 1/4 OF THE NW 1/4 SEC. 4	0.09	0.04	FEE

Document No. 383319

I hereby certify that this instrument was filed in the office of the County Recorder for record this 24th day of April, 1995, at 1:00 o'clock P.M., and was duly recorded in the Goodhue County Records as file number 318A.

Craig Anderson
Craig Anderson Deputy
Goodhue County Recorder