

GOODHUE COUNTY RIGHT OF WAY PLAT NO. 132

County Road No. 45

The County of Goodhue, a body politic and corporate under the laws of the State of Minnesota, pursuant to Minnesota Statutes Chapter 160.085, has caused the right of way of County Road 45 to be mapped as it transgresses over and across the following described lands situated in the County of Goodhue, Minnesota, to wit:

That part of said right of way included in the following described tracts of land:

Section 2, Township 111 North, Range 14 West:
Northeast Quarter of the Southeast Quarter

The Board of County Commissioners for Goodhue County, Minnesota, is hereby designating the right of way of County Road No. 45 as indicated on GOODHUE COUNTY RIGHT OF WAY PLAT NO. 132.

Certified by: Greg Jackson Date: 8-18-00
Greg Jackson, P.E.
Goodhue County Engineer
MN License 21765

I hereby certify that this plat was prepared by me or under my direct supervision and that I am a duly Licensed Land Surveyor under the laws of the State of Minnesota, that this plat meets the requirements of Minnesota Statutes Chapter 160.085, that all measurements are correctly shown on the plat, and that the plat right of way boundary is correctly designated on this plat.

Certified by: Lisa M. Skipton Date: 8/18/2000
Lisa M. Skipton, L.S.
Goodhue County Surveyor
MN License 23048

Document No. 443833

I hereby certify that this instrument was file in the office of the County Recorder for record this 28th day of Aug., 2000, at 8:00 o'clock A.m. and was duly recorded in the Goodhue County Records as file number 339 B

By: Linda Tuttle by S. Huber
Linda Tuttle
Goodhue County Recorder

Right of Way in Section 2, T111N, R14W					
Parcel	Owner	Location	Exist. Hwy R/W	New Hwy R/W	Total R/W in FEE Interest
1	Gerald A. Burfeind Mary Ann Burfeind	NE1/4 SE1/4	1.38 ac	0.91 ac	2.29 ac
2	Mark G. Burfeind Diane S. Burfeind	NE 1/4 SE1/4	0.48 ac	0.08 ac	0.48 ac

LEGEND

- Plat Boundary
- Parcel line
- Existing RW
- Section Line
- Quarter Line
- Sixteenth Line
- Goodhue Co. Mon.
- Goodhue Co. RW Mon.

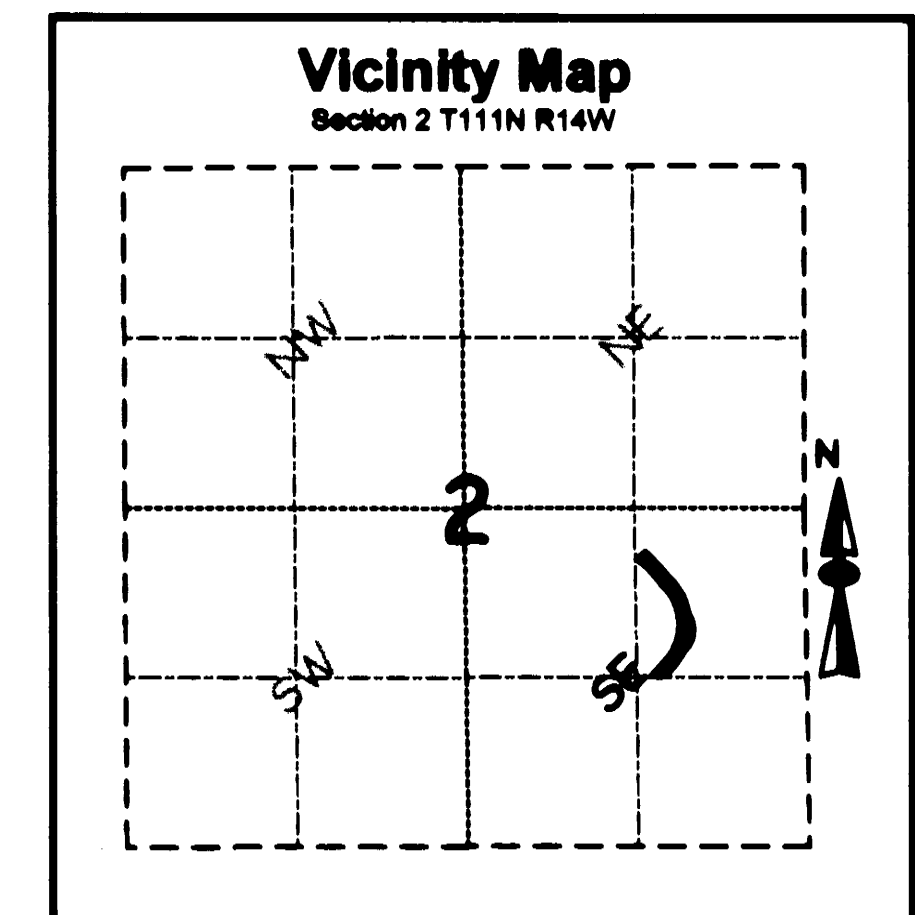

Goodhue County ROW monuments are 5/8" by 24" rebar with a 2" aluminum cap marked "Goodhue County RW LS 23048" and will be placed in the ground after construction is complete.

This azimuth system is based on the NAD 1983 Adjustment of the Goodhue County coordinate system with the North being 00 degrees 00 minutes 00 seconds, and all azimuths are referenced clockwise from North.

Subject to easements of record, if any.

