

VICINITY MAP
Section 29 T.112 N., R15 W

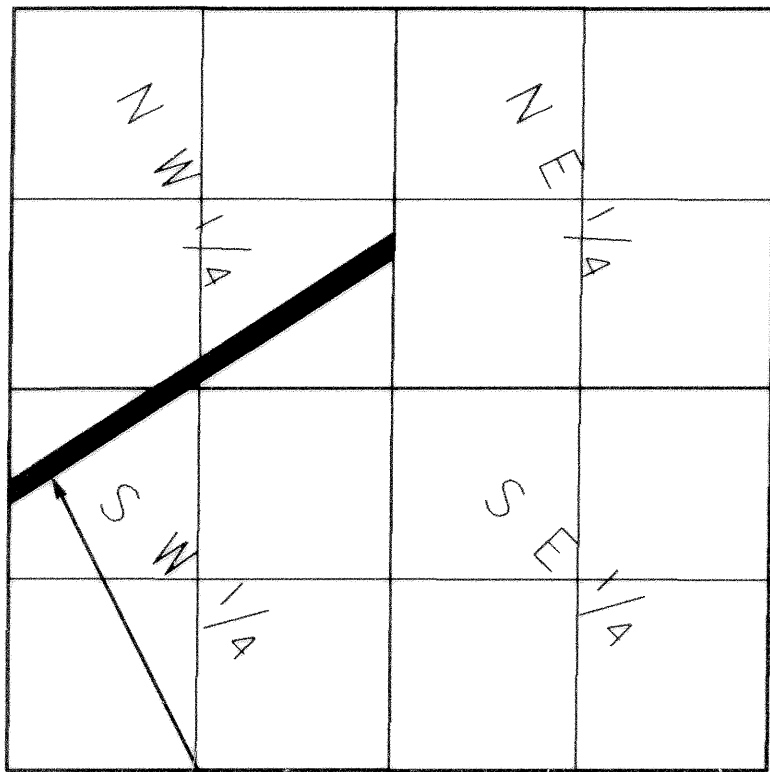

PLAT NO. 165

GOODHUE COUNTY RIGHT OF WAY PLAT NO. 165

County State Aid Highway No. 1

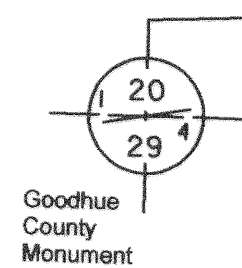

Goodhue County Monument

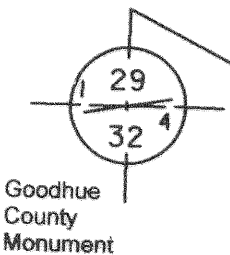

Goodhue County Monument

SW 1/4 - NW 1/4

SE 1/4 - NW 1/4

NW 1/4 - SW 1/4

NE 1/4 - SW 1/4

C.S.A.H. No. 6 (EXISTING ALIGNMENT)

C.S.A.H. No. 6 (EXISTING ALIGNMENT)

The County of Goodhue, a body politic and corporate under the laws of the State of Minnesota, pursuant to Minnesota Statutes Chapter 160.085, has caused the right of way of County State Aid Highway No. 1 to be mapped as it transgresses over and across the following described lands in the County of Goodhue, Minnesota, to wit:
That Part of Said Right of Way included in the following described tracts of land:

Section 29, Township 112 North, Range 15 West:
Southwest Quarter & Northwest Quarter

The Board of Commissioners for Goodhue County, Minnesota, is hereby designating the right of way of C.S.A.H. 1 as shown on GOODHUE COUNTY RIGHT OF WAY PLAT NO. 165

Certified by *Rory Isakson* this *12th* day of *March*, 2004

Greg Isakson, P.E.
Goodhue County Engineer
MN License 21765

I hereby certify that this plat was prepared by me or under my direct supervision and that I am a duly Licensed Land Surveyor under the laws of the State of Minnesota, that this plat meets the requirements of Minnesota Statutes Chapter 160.085, that all measurements are correctly shown on the plat, and that the plat right of way boundary is correctly designated on this plat

Certified by *Lisa M. Skipton* this *24* day of *March*, 2004

Lisa M. Skipton, L.S.
Goodhue County Surveyor
MN License 23048

Document No. *502106*

I hereby certify that this instrument was filed in the office of the County Recorder for record this day of *March*, 2004, at *1:00* o'clock *Pm* and was duly recorded in the Goodhue County Records as file number *GC-165*

By *Jean M. Dankers*

Jean M. Dankers
Goodhue County Recorder

Right of Way in Section 29, T.112N., R.15W

PARCEL NO.	OWNER	LOCATION	EXISTING HIGHWAY R/W	NEW HIGHWAY R/W	TOTAL R/W IN FEE INTEREST
1	DUANE HANSON aka DUANE W HANSON MARILYN G HANSON	NW 1/4 OF SW 1/4 SECTION 29	1.35 AC	0.17 AC	1.52 AC
2	ROBERT A DOSDALL	NW 1/4 OF SW 1/4 SECTION 29	0.60 AC	0.0 AC	0.60 AC
3	STEVEN P CARLSON LINNAE M CARLSON	SW 1/4 OF NW 1/4 SECTION 29	0.005 AC	0.00 AC	0.005 AC
4	ALLAN L LARSON GAYE L LARSON	SE 1/4 OF NW 1/4 SECTION 29	1.49 AC	0.17 AC	1.66 AC
5	ARTHUR W GADIENT DONALD B GADIENT	SE 1/4 OF NW 1/4 SECTION 29	2.19 AC	0.47 AC	2.66 AC
6	ROBERT A DOSDALL	SE 1/4 OF NW 1/4 NE 1/4 OF SW 1/4 SECTION 29	0.18 AC	0.07 AC	0.25 AC
7	DAVID R MEINCKE ARLIS MEINCKE	NW 1/4 OF SW 1/4 SECTION 29	1.63 AC	0.54 AC	2.17 AC



This azimuth system is based on the HARN Adjustment of NAD 1983
Goodhue County coordinate system with the
North being 00 degrees 00 minutes 00 seconds, and
all azimuth are referenced clockwise from north.

This plat is subject to easments of record.

LEGEND

- Plat Boundary
- Parcel Line
- Deed Line
- Existing Right of Way
- Section Line
- Quarter Line
- Sixteenth Line
- Goodhue County Monument
- Found Monument