

March Addition to Zumbrota Village
 East one half of lot 8 Sec 36 Town 110 R 16

State of Minnesota }
 Goodhue County } ss.

Know all men by these presents; that we the undersigned -
 F.M. March and Emma H. March his wife are owners in fee of those parts of
 the East one half of Lot 8 of the North East quarter of Section 36 Town 110 Range
 16 beginning at the South East corner of said lot 8 at an iron pin there
 running North 660 feet then West 330 feet then South 660 feet then East 330 feet
 to place of beginning all lying and being situate in the Village of Zumbrota
 County of Goodhue and State of Minnesota do hereby certify that we have
 caused the said described premises to be surveyed and platted into lots
 and blocks and this plat thereof to be made and a good and sufficient Iron
 monument to be planted at the intersection of 4th Street & Warren Avenue and
 Maple Street and Warren Avenue so on the plat designated and the lots and
 Blocks therein to be progressively numbered their precise length and width
 to be stated, together with the name width courses boundaries and extent
 of all streets therein as the same are specifically set forth on the within
 plat; we do further certify the name and designation of the said premises
 so platted in and shall be March addition to Zumbrota; and we do hereby
 give and dedicate to and for the use and easement of the public the streets
 in said addition surveyed and platted as herein represented
 In witness whereof we have hereto set our hands and seal this 14th
 day of August 1895.

A. C. Eastman }
 Henry Ahnesman } Witnesses.

F.M. March }
 Emma H. March }
 A.C. Eastman }
 Notary Public }
 Goodhue Co. }
 Minn. }

State of Minnesota } ss.
 County of Goodhue }
 On this fourteenth day of August 1895 personally came
 before me F.M. March and Emma H. March the identical persons who
 executed the foregoing certificate and acknowledged the same to be their free
 act and deed.

Not
 Seal

A.C. Eastman
 Notary Public
 Goodhue Co.
 Minn.

Office of Village Clerk

of the Village of Zumbrota. This is to certify that at a meeting of
 the Village Council held on the 14th day of August 1895 this plat of March Addition
 to the Village of Zumbrota was approved by said Village Council of the Village of Zumbrota.
 Given under my hand and the corporate seal of the said Village of Zumbrota
 Dated this 15th day of August 1895.

Attest - H.H. Kinne

Village Recorder

William F. Burns
 Village Presdt.

I hereby certify that this is a true map of March addition to Zumbrota as surveyed by
 me, and that the same is situate upon and comprises the premises described in
 the annexed certificate of the proprietor thereof; that the same were by me
 actually surveyed and that the numbers names sizes and extent of are actu-
 ally set forth on the annexed plat. In testimony whereof I have hereunto
 set my hand and seal this 7th day of August 1895.

William Dauforth County Surveyor

State of Minnesota } ss.
 County of Goodhue }
 On this 7th day of August 1895 personally came before
 me William Dauforth County Surveyor the identical person who executed the
 foregoing certificate and acknowledged his execution thereof.

Not
 Seal

Carl N. Lien
 Notary Public
 Goodhue Co.
 Minn.

Transferred Taxes paid
 August 22nd A.D. 1895.

Carl N. Lien
 County Auditor
 Ray Dana Deputy.

No. 15009.

Filed for Record this 11th day
 of September A.D. 1895 at 8 O'clock A.M.

J. H. Heberter
 Registrar of Deeds
 Goodhue County
 Minnesota.

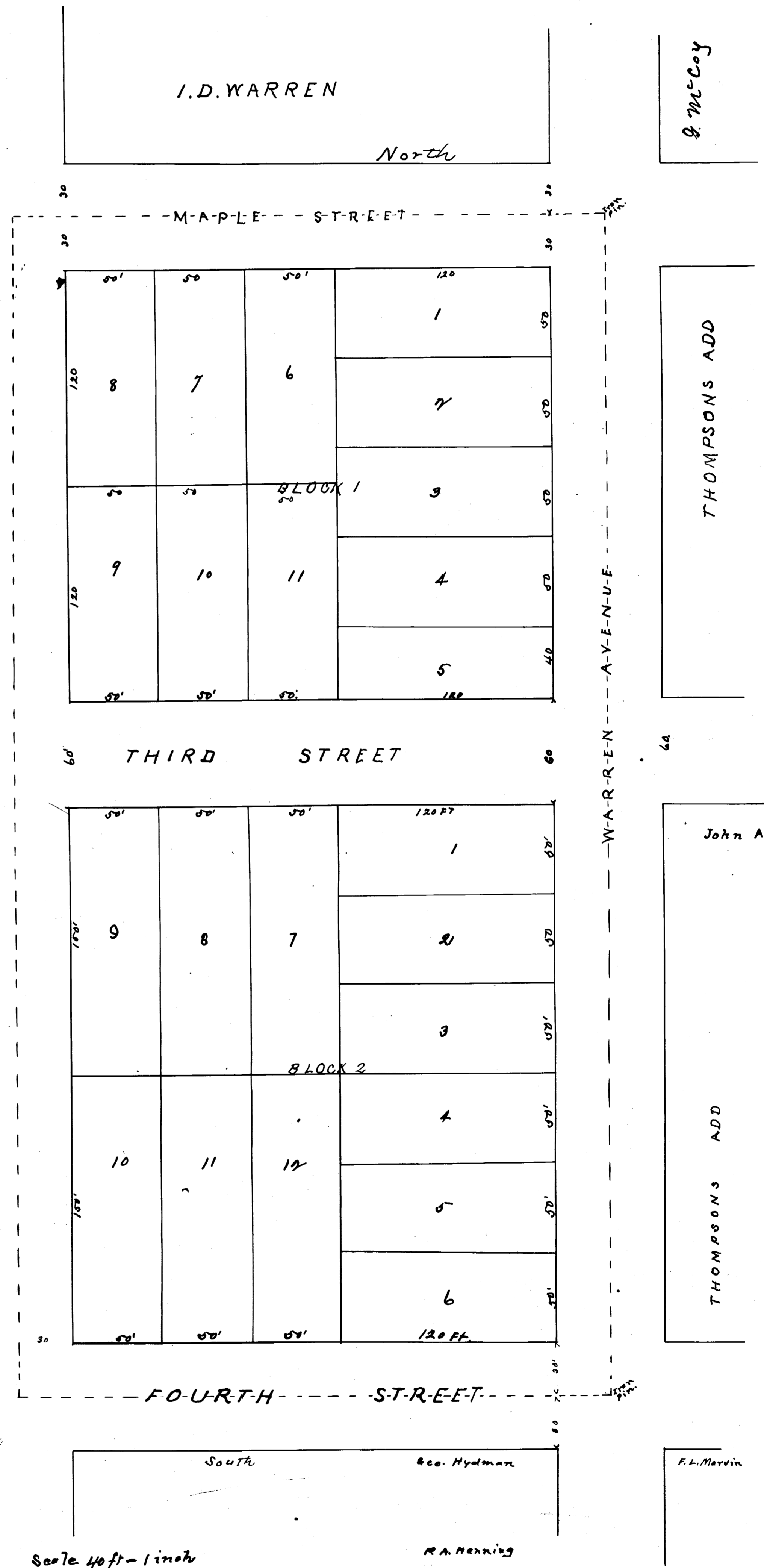

G. McCoy

THOMPSONS ADD

John Anderson

THOMPSONS ADD

F.L. Marvin