

# BUSINESS PARK NORTH SECOND REPLAT

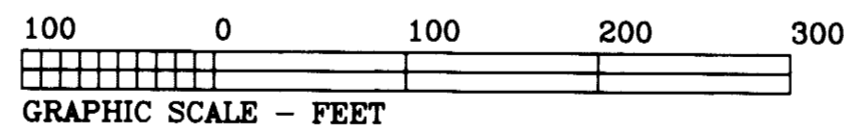
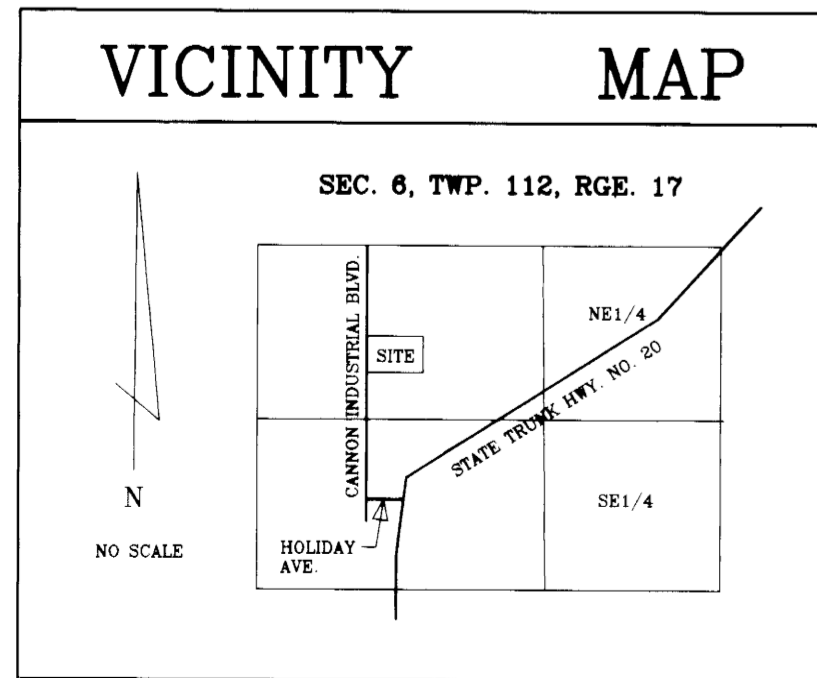
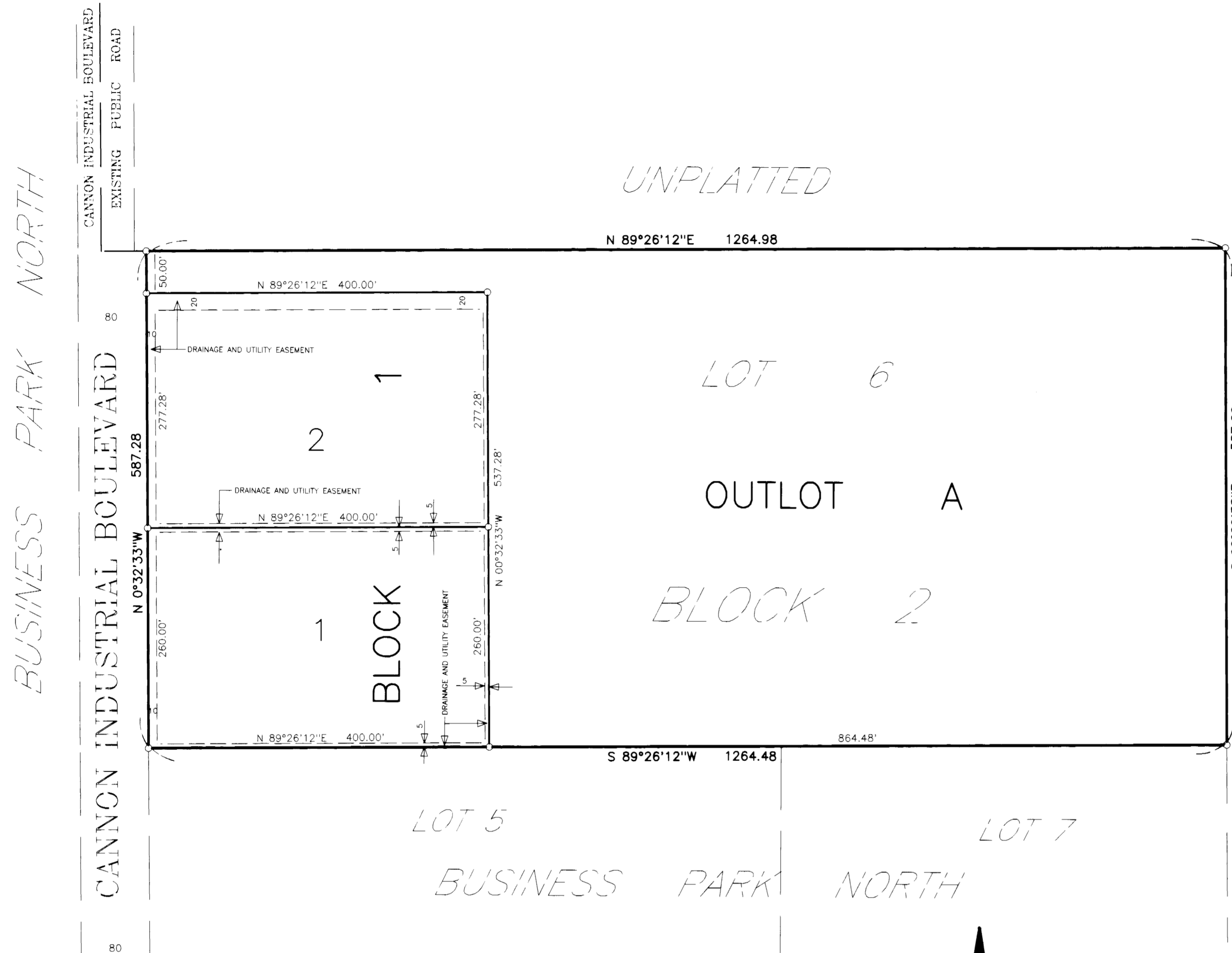

o DENOTES PLACED 1/2 INCH BY 14 INCH PIPE HAVING A PLASTIC CAP MARKED R.L.S. 16998 UNLESS OTHERWISE INDICATED.

THE WEST LINE OF BLOCK 1, BUSINESS PARK NORTH FIRST REPLAT IS ASSUMED TO HAVE A BEARING OF N0°32'33\"/>

UNPLATTED

LOT 6

OUTLOT A

BLOCK 2

UNPLATTED

KNOW ALL MEN BY THESE PRESENTS: That the Economic Development Authority In And For The City Of Cannon Falls, a body politic and corporate, fee owner, of the following described property situated in the County of Goodhue, State of Minnesota, to wit:

Lot 6, Block 2, BUSINESS PARK NORTH, according to the recorded plat thereof, on file and of record in the office of the County Recorder, Goodhue County, Minnesota.

Has caused the same to be surveyed and platted as BUSINESS PARK NORTH SECOND REPLAT and does hereby dedicate to the public, for public use the drainage and utility easements as shown on the plat.

In witness whereof Leon Hanson and Dallas Larson of the Economic Development Authority In And For The City Of Cannon Falls, have hereunto set their hands this 15 day of Nov, 1999.

*Leon Hanson*  
Leon Hanson, President

*Dallas Larson*  
Dallas Larson, Secretary

State of Minnesota  
County of Goodhue

The foregoing instrument was acknowledged before me this 15 day of November, 1999 by Leon Hanson, president and Dallas Larson, secretary of the Economic Development Authority In And For The City Of Cannon Falls, a body politic and corporate, on behalf of the corporation.

*Mary A. Fox*  
Notary Public, Goodhue County, Minnesota  
My Commission Expires 1/1/2000

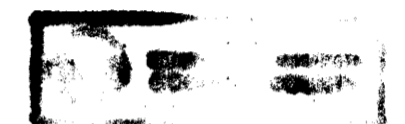

I hereby certify that I have surveyed and platted the property described on this plat as BUSINESS PARK NORTH SECOND REPLAT that this plat is a correct representation of said survey; that all distances are correctly shown on said plat in feet and hundredths of a foot; that all monuments have been correctly placed in the ground as shown on said plat; that the outside boundary lines are correctly designated on said plat; and there are no wet lands as defined in MS 505.02 subd. 1, or Public Highways to be designated on said plat, other than as shown.

*V. Richard Samuelson*  
V. Richard Samuelson, Land Surveyor  
Minnesota License Number 16998

State of Minnesota  
County of Goodhue

The foregoing instrument was acknowledged before me this 18TH day of OCT., 1999 by V. Richard Samuelson, Land Surveyor, License No. 16998.

*Natalie J. Relland-Vath*  
Notary Public, Goodhue County, Minnesota  
My Commission Expires 1-31-2000



Reviewed by the Planning Commission of the City of Cannon Falls, Minnesota this 12 day of July, 1999.

SIGNED: *Robert...* Chairman ATTEST: *Dallas Larson* Secretary

Approved by the City of Cannon Falls, Minnesota, this 15 day of July, 1999.

SIGNED: *Dean Hansen* Mayor ATTEST: *Dallas Larson* City Clerk

Taxes payable in the year 1999 on the land herein described have been paid, there are no delinquent taxes and transfer has been entered this 19th day of Nov, 1999.

*Jeanne...*  
Goodhue County Auditor/Treasurer

By: \_\_\_\_\_ Deputy

Pursuant to Chapter 389.09, laws of Minnesota, as amended in 1976, and Goodhue County Ordinance No. 2-78, this plat has been approved this 19th day of November, 1999.

*Paul M. Skampton*  
Goodhue County Surveyor

I hereby certify that the within instrument was filed in this office for record this 22nd day of November, 1999 at 11:00 o'clock, P M and was duly recorded as document number 43587, file number 270A.

*Craig Anderson*  
Goodhue County Recorder

PHONE: (507) 263-3274

**SAMUELSON SURVEYING INC.**

118 North Fourth Street  
Cannon Falls, MN. 55009

V. Richard Samuelson  
Registered Land Surveyor

