

MARVIN SATHRUM ADDITION

KNOW ALL MEN BY THESE PRESENTS: That the City of Wanamingo, a municipal corporation, fee owner, Wanamingo Economic Development Authority, a political subdivision, fee owner, Jason D. Raths and Amy S. Raths, husband and wife, fee owners, Bank of Zumbrota, a Minnesota corporation, mortgagee, John T. Masters and Karen M. Masters, husband and wife, fee owners, and Security State Bank of Kenyon, a Minnesota corporation, mortgagee of the following described property situated in the County of Goodhue, State of Minnesota, to wit:

Outlot C, Lots 1, 2, 3 and 4, Block 2, WANAMINGO ELEVATOR ADDITION, according to the recorded plat thereof, Goodhue County, Minnesota. EXCEPT that part of said Lot 4, Block 2, WANAMINGO ELEVATOR ADDITION described as follows: Commencing at the most northerly corner of said Lot 4; thence South 76 degrees 31 minutes 25 seconds West (assumed bearing) along the most northerly line of said Lot 4, a distance of 253.30 feet to the point of beginning; thence continuing South 76 degrees 31 minutes 25 seconds West along said northerly line 102.52 feet; thence South 00 degrees 44 minutes 05 seconds East 153.79 feet; thence South 76 degrees 31 minutes 25 seconds West along a north line of said Lot 4, a distance of 200.00 feet; thence South 00 degrees 44 minutes 05 seconds East 51.26 feet; thence North 76 degrees 31 minutes 25 seconds East 302.52 feet; thence North 00 degrees 44 minutes 05 seconds West 205.04 feet to the point of beginning.

Have caused the same to be surveyed and platted as MARVIN SATHRUM ADDITION and do hereby dedicate to the public, for public use the street and avenues and also dedicate the drainage and utility easements as shown on the plat.

In witness whereof The City of Wanamingo, a municipal corporation, has caused these presents to be signed by its proper officers this 27th day of June, 2002.

Signed James H. Kiffmeyer Mayor
Elmer Bricker Administrator

State of Minnesota
County of Goodhue

The foregoing instrument was acknowledged before me this 27th day of June, 2002, by James Kiffmeyer, Mayor, and Elmer Bricker, Administrator of the City of Wanamingo, a municipal corporation, on behalf of the corporation.

Jane E. Andrist
Notary Public, Goodhue County, Minnesota
My Commission expires January 31, 2005.

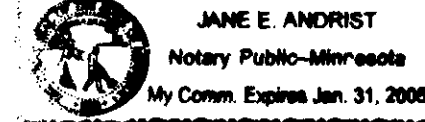

In witness whereof the Wanamingo Economic Development Authority, a political subdivision, has caused these presents to be signed by its proper officers this 27th day of June, 2002.

Signed Tracy Schaefer President
Elmer Bricker Director

State of Minnesota
County of Goodhue

The foregoing instrument was acknowledged before me this 27th day of June, 2002, by Tracy Schaefer, President, and Elmer Bricker, Director of the Wanamingo Economic Development Authority, a political subdivision, on behalf of the association.

Jane E. Andrist
Notary Public, Goodhue County, Minnesota
My Commission expires January 31, 2005.

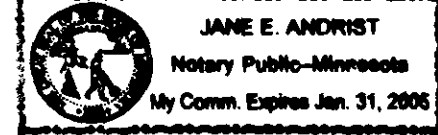

In witness whereof, said Jason D. Raths and Amy S. Raths, husband and wife, have hereunto set their hands this 27th day of June, 2002.

State of Minnesota
County of Goodhue
Jason D. Raths Amy S. Raths

The foregoing instrument was acknowledged before me this 27th day of June, 2002, by Jason D. Raths and Amy S. Raths, husband and wife, this 27th day of June, 2002.

Elmer Bricker
Notary Public, Goodhue County, Minnesota
My Commission expires January 31, 2005.

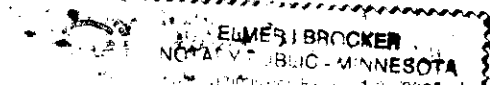

In witness whereof said Bank of Zumbrota, a Minnesota Corporation, has caused these presents to be signed by its proper officers this 17th day of July, 2002.

Jeff Perra President
Charles Sturm Senior Vice President

State of Minnesota
County of Goodhue

The foregoing instrument was acknowledged before me this 17th day of July, 2002, by Jeff Perra and Charles Sturm of Bank of Zumbrota, a Minnesota corporation, on behalf of the corporation.

Elmer Bricker
Notary Public, Goodhue County, Minnesota
My Commission expires January 31, 2005.



In witness whereof, said John T. Masters and Karen M. Masters, husband and wife, have hereunto set their hands this 16th day of July, 2002.

State of Minnesota
County of Goodhue
John T. Masters Karen M. Masters

The foregoing instrument was acknowledged before me this 16th day of July, 2002, by John T. Masters and Karen M. Masters, husband and wife, this 16th day of July, 2002.

Elmer Bricker
Notary Public, Goodhue County, Minnesota
My Commission expires January 31, 2005.

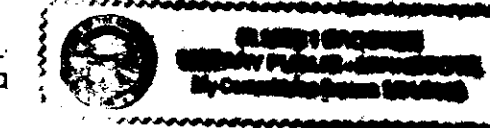

In witness whereof said Security State Bank of Kenyon, a Minnesota Corporation, has caused these presents to be signed by its proper officers this 16th day of July, 2002.

Jeff Ellingson President
Harvey Fossum Senior Vice President

State of Minnesota
County of Goodhue

The foregoing instrument was acknowledged before me this 16th day of July, 2002, by Jeff Ellingson and Harvey Fossum of Security State Bank of Kenyon, a Minnesota corporation, on behalf of the corporation.

Elmer Bricker
Notary Public, Goodhue County, Minnesota
My Commission expires January 31, 2005.

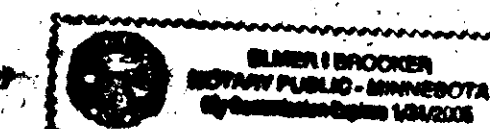

I hereby certify that I have surveyed and platted the property described on this plat as MARVIN SATHRUM ADDITION, that this plat is a correct representation of said survey, that all distances are correctly shown on said plat in feet and hundredths of a foot, that all monuments have been correctly placed in the ground as shown on said plat, that the outside boundary lines are correctly designated on said plat, and there are no wetlands as defined in Minnesota Statutes 505.02, Subd. 1, or Public Highways to be designated on said plat, other than as shown.

David G. Rapp
David G. Rapp, Land Surveyor
Minnesota License No. 22044

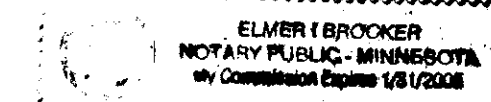

State of Minnesota
County of Goodhue

The foregoing instrument was acknowledged before me this 26th day of June, 2002, by David G. Rapp, Land Surveyor.

Elmer Bricker
Notary Public, Goodhue County, Minnesota
My Commission expires January 31, 2005.

Reviewed by the Economic Development Authority of the City of Wanamingo, Minnesota, on this 20th day of May, 2002.

Signed: Tracy Schaefer President Attest: Elmer Bricker Director
Approved by the City of Wanamingo, Minnesota this 20th day of May, 2002.

Signed: James H. Kiffmeyer Mayor Attest: Jane E. Andrist City Clerk

Taxes payable in the year 2002 on the land herein described have been paid, there are no delinquent taxes and transfer has been entered this 24th day of July, 2002.

Brad Johnson By Theresa Deputy
Goodhue County Auditor/Treasurer

Pursuant to Chapter 389.09, laws of Minnesota, and Goodhue County Ordinance No. 2-78, this plat has been approved this 22nd day of July, 2002.

Lisa M. Skipton
Lisa M. Skipton, Goodhue County Surveyor

I hereby certify that the within instrument was filed in this office for record this 24th day of July, 2002, at 8:00 o'clock a.m. and was duly recorded as document number 470670, file number 308A.

Jean M. Dankers
Goodhue County Recorder

RAPP LAND SURVEYING
45967 HIGHWAY 56 BLVD
KENYON, MN 55946
(507) 789-5366

MARVIN SATHRUM ADDITION

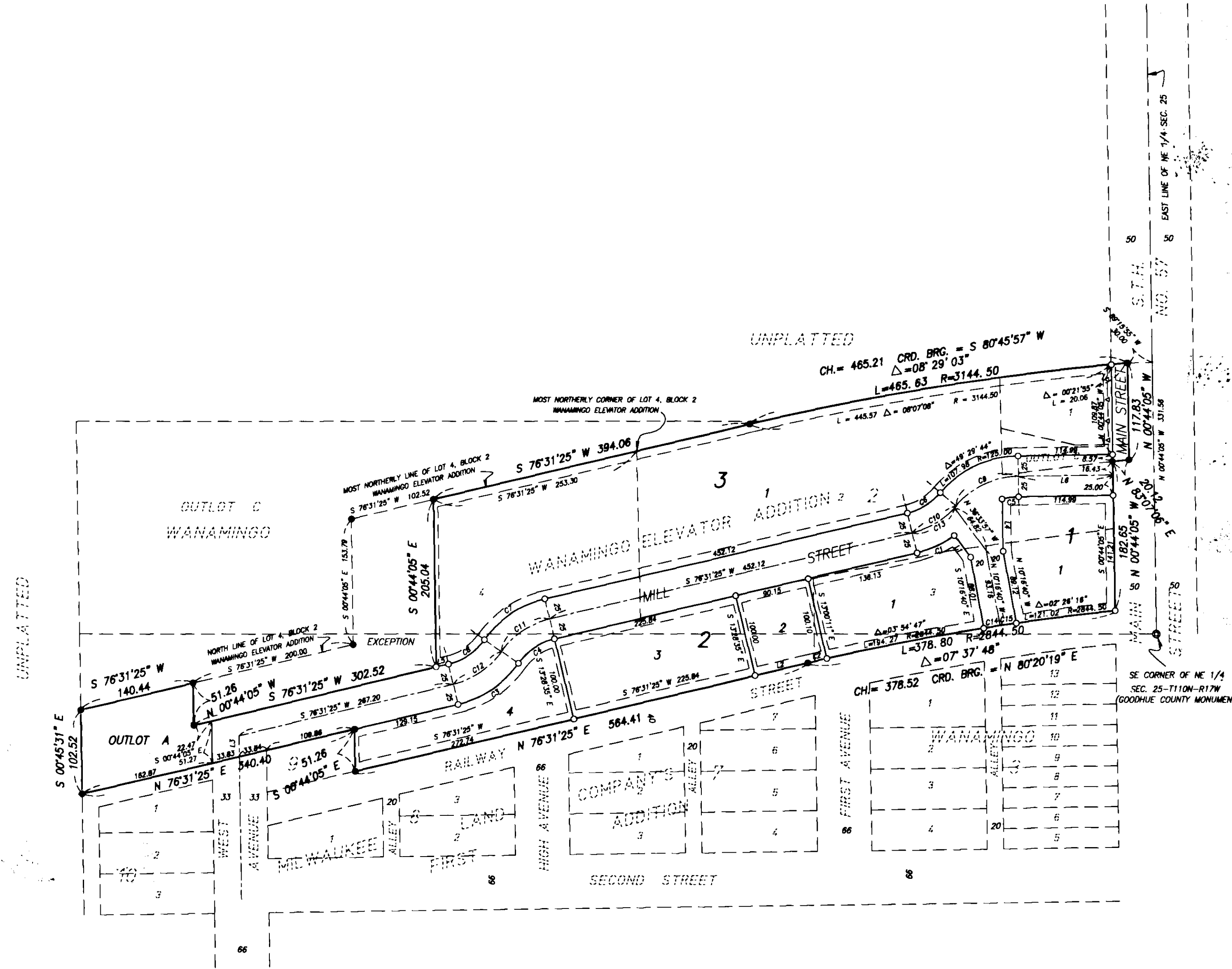

LINE	BEARING	DISTANCE
L1	S 36°33'57" E	33.13
L2	S 76°31'25" W	65.83
L3	S 00°44'05" E	25.84
L4	N 00°46'03" W	83.93
L5	S 76°31'25" W	15.33
L6	S 89°15'55" W	114.99

CURVE	ARC	DELTA	RADIUS
C1	50.37	23°05'22"	125.00
C2	23.49	00°28'24"	2844.50
C3	90.34	41°24'27"	125.00
C4	54.20	41°24'27"	75.00
C5	20.34	15°32'26"	75.00
C6	48.11	36°45'14"	75.00
C7	90.34	41°24'27"	125.00
C8	54.20	41°24'27"	75.00
C9	86.39	49°29'44"	100.00
C10	64.15	36°45'14"	100.00
C11	72.27	41°24'27"	100.00
C12	72.27	41°24'27"	100.00
C13	80.43	34°37'35"	100.00
C14	20.01	00°24'11"	2844.50
C15	20.01	00°24'11"	2844.50

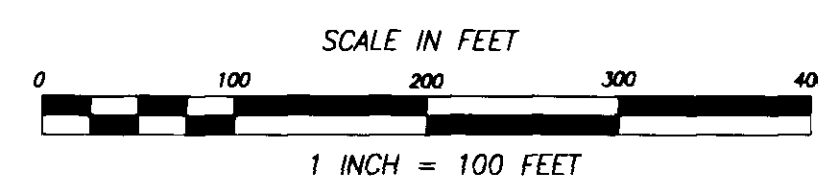
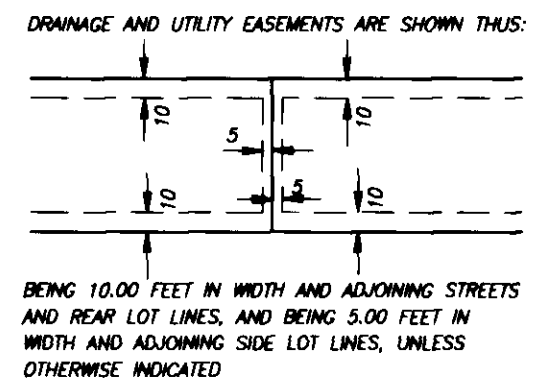
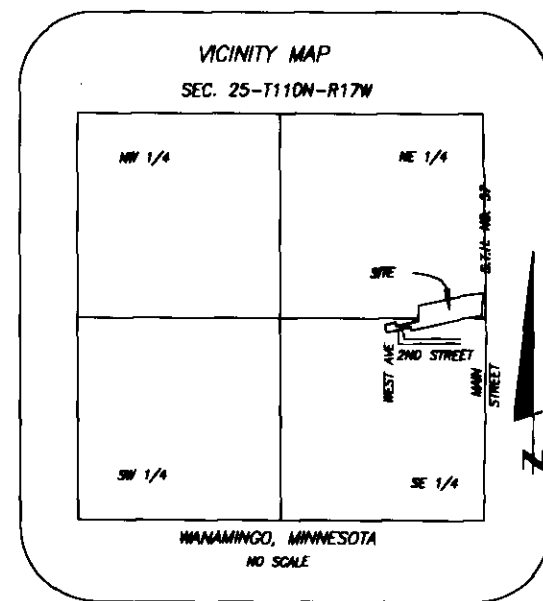

BEARINGS ARE BASED ON THE ASSUMPTION THAT THE EAST LINE OF THE NORTHEAST QUARTER OF SECTION 25-1110M-R17W HAS A BEARING OF N 00°44'05" W.

○ DENOTES SET 1/2" x 1/4" IRON PIPE MONUMENT WITH PLASTIC CAP MARKED RLS 22044 UNLESS OTHERWISE INDICATED

● DENOTES FOUND IRON PIPE MONUMENT

—△—△—△— DENOTES CONTROLLED ACCESS

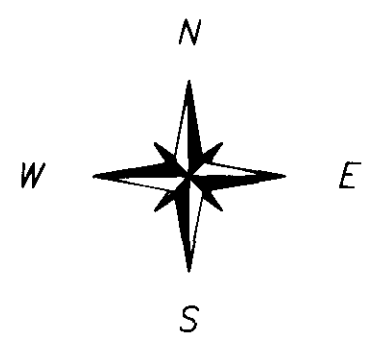

RAPP LAND SURVEYING
45967 HIGHWAY 56 BLVD
KENYON, MN 55946
(507) 789-5366