

FOLDCRAFT ADDITION

KNOW ALL MEN BY THESE PRESENTS: That Foldcraft Co., a Minnesota corporation, owner and proprietor, and Norwest Bank Minnesota South, National Association, a national banking association, mortgagee, of the following described property to wit:

That part of the NE 1/4 of Section 9, Township 109, Range 18, Goodhue County, Minnesota, being a strip of land 100.00 feet wide lying 50 feet on each side of the centerline of the main track of the Chicago, Milwaukee, St. Paul and Pacific Railroad Company, as located on June 30, 1980, said main track centerline being described as follows: Commencing at the northeast corner of said NE 1/4 of Section 9; thence on an assumed bearing of South 88 degrees 49 minutes 27 seconds West, along the north line of said NE 1/4 of Section 9, a distance of 1284.11 feet to the east right of way line of Red Wing Avenue, as now located and established; thence South 00 degrees 09 minutes 07 seconds East, along said East right of way line, a distance of 201.03 feet to the point of beginning of said main track centerline to be described; thence South 89 degrees 58 minutes 07 seconds East, along said main track centerline, a distance of 199.08 feet; thence easterly along said main track centerline, being a tangential curve concave to the North, having a radius of 12138.65 feet and a central angle of 03 degrees 36 minutes 33 seconds, a distance of 764.64 feet to the westerly right of way line of State Trunk Highway Number 56, as described in Book 69 of M.R., page 21, on file in the office of Goodhue County Recorder, and there terminating. The sidelines of said strip are to be prolonged or shortened to terminate on said East right of way line of Red Wing Avenue and said westerly right of way line of State Trunk Highway Number 56.

AND

That part of the E 1/2 of the NE 1/4 of Section 9, Township 109 North, Range 18 West, lying southerly of that certain tract of land conveyed to Harold R. Nielsen in Book Z-12 of Deeds, page 38; northerly of that certain tract of land conveyed to Harold R. Nielsen in Doc. No. 294300; easterly of the northerly extension of the westerly line of that certain tract of land conveyed to Harold R. Nielsen in Doc. No. 294300; and westerly of the westerly right of way line of State Highway No. 56.

AND

That part of the East Half of the Northeast Quarter of Section 9, Township 109 North, Range 18 West, Goodhue County, Minnesota, described as follows:

Beginning at a point 303 feet east and 255 feet south of the northwest corner of the East Half of the Northeast Quarter of said Section 9; thence south, parallel with the west line of the East Half of the Northeast Quarter, a distance of 407 feet to the intersection with a line perpendicular to the centerline of Red Wing Avenue, drawn westerly from a point on the east line of the Northeast Quarter of said Section 9, distant 1960.29 feet north from the southeast corner of the Northeast Quarter of said Section 9; thence west, perpendicular to said centerline of Red Wing Avenue, a distance of 120.71 feet, to the intersection with a line parallel with and distant 183 feet easterly from said centerline of Red Wing Avenue, as measured at a right angle to said centerline; thence south, along said parallel line, a distance of 979.78 feet; thence North 89 degrees 11 minutes 17 seconds West, a distance of 150.02 feet to the easterly right of way line of said Red Wing Avenue; thence southerly, along said easterly right of way line, a distance of 66.01 feet to the northwesterly corner of the John L. Cole property, as described in Goodhue County Document Number 292575; thence easterly, a distance of 230.03 feet to the northeast corner of said Cole property; thence southerly, along the easterly line of said Cole property and its southerly extension, a distance of 929.54 feet to the south line of the East Half of the Northeast Quarter of said Section 9; thence easterly, along said south line, a distance of 1058.85 feet to the southeast corner of the Northeast Quarter of said Section 9; thence northerly, along said east line, a distance of 1853.23 feet, to the southwesterly right of way line of State Highway Number 56; thence northwesterly, along said southwesterly right of way line, to the intersection with a line drawn easterly, perpendicular to the west line of the East Half of the Northeast Quarter of said Section 9, from the point of beginning; thence westerly, along said perpendicular line, to the point of beginning.

Have caused the same to be surveyed and platted as FOLDCRAFT ADDITION, and do hereby donate and dedicate to the public, for public use, the thoroughfares as shown on the plat.

In witness whereof said Foldcraft Co., a Minnesota corporation, has caused these presents to be signed by its proper officers this 22ND day of OCTOBER, 2003.

SIGNED:

FOLDCRAFT CO.

John C. Sheppard
Charles H. Mayhew

its CHIEF EXECUTIVE OFFICER

and

its PRESIDENTSTATE OF MINNESOTA
COUNTY OF DAKOTA

The foregoing instrument was acknowledged before me this 22ND day of OCTOBER, 2003, by STEPHEN C. SHEPPARD, its CHIEF EXECUTIVE OFFICER, and CHARLES H. MAYHEW, its PRESIDENT, of Foldcraft Co., a Minnesota corporation.

Donald J. Ruegel
 Notary Public DAKOTA County, Minnesota
 My Commission Expires JANUARY 31, 2005

Donald J. Ruegel
 Notary Public DAKOTA County, Minnesota
 My Commission Expires JANUARY 31, 2005

And in witness whereof Norwest Bank Minnesota South, National Association, a national banking association, has caused these presents to be signed by its proper officers this 16 day of January, 2004.

SIGNED:

WELLS FARGO BANK MINNESOTA, N.A., formerly
NORWEST BANK MINNESOTA SOUTH, NATIONAL ASSOCIATION

Timothy M. McManimon
Thomas Redalen

its PRESIDENT

and

its VICE PRESIDENTSTATE OF MINNESOTA
COUNTY OF STECKE

The foregoing instrument was acknowledged before me this 16th day of January, 2004, by

TIMOTHY M. MC MANIMON, its PRESIDENT, and THOMAS REDALEN, its VICE PRESIDENT, of WELLS FARGO BANK, Minnesota South, National Association, a national banking association.

John M. Carlson
 Notary Public STECKE County, Minnesota
 My Commission Expires LATES

MINNESOTA, N.A., formerly

I hereby certify that I have surveyed and platted the property described on this plat as FOLDCRAFT ADDITION; that this plat is a correct representation of said survey; that all distances are correctly shown on said plat in feet and hundredths of a foot; that all monuments have been correctly placed in the ground as shown on said plat; that the outside boundary lines are correctly designated on said plat; and there are no wet lands, as defined in MS 505.02, Subd. 1, or public highways to be designated on said plat, other than as shown.

David A. Johnson
 David A. Johnson, Land Surveyor
 Minnesota License Number 12788

STATE OF MINNESOTA
COUNTY OF GOODHUE

The foregoing instrument was acknowledged before me this 13th day of April, 2004, by *Beverly Lundquist*, Notary Public Goodhue County, Minnesota, My commission expires January 31, 2005.

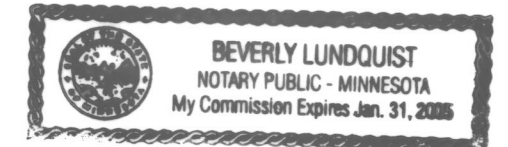

Pursuant to Chapter 389.09, laws of Minnesota and Goodhue County Ordinance No. 2-78, this plat has been approved this 9th day of June, 2004.

By *Lisa M. Skipton Hann*
 Lisa M. Skipton Hann,
 Goodhue County Surveyor

Approved by the Planning Commission of Kenyon, Minnesota, this 9th day of October, 2004.

Signed *Mandy D. Merveth*
 Mandy D. Merveth, Chairman

Signed *Aaron S. Reuser*
 Aaron S. Reuser, Secretary

Approved by the City Council of Kenyon, Minnesota, this 14th day of December, 2004.

Signed *Thomas E. Thunderson*
 Thomas E. Thunderson, Mayor

Signed *Aaron S. Reuser*
 Aaron S. Reuser, City Clerk

I hereby certify the taxes payable in the year 2005 on the land herein described have been paid, there are no delinquent taxes and transfer has been entered this 9th day of June, 2005.

By *B. J. Johnson*
 Goodhue County Auditor/Treasurer
 By *Donald J. Ruegel*
 Deputy
 Date 8/10/15

I hereby certify that the within instrument was filed in this office for record this 9th day of June, 2005, at 1:00 o'clock P. m. and was duly recorded as document number 519280 file number 3228.

By *Lisa M. Skipton Hann*
 Goodhue County Recorder

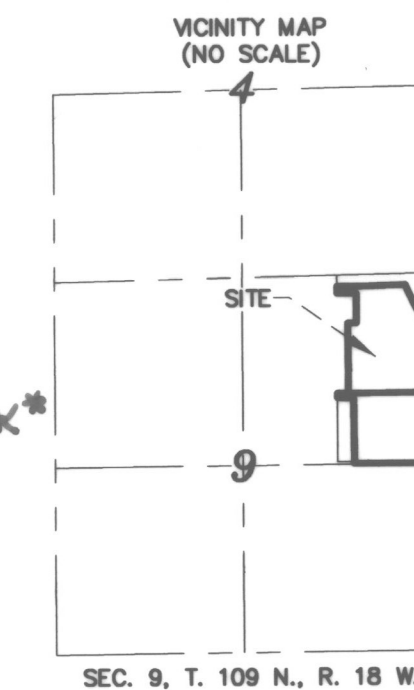

- DENOTES A PLACED 1" BY 18" IRON PIPE HAVING A PLASTIC CAP BEARING LAND SURVEYOR LICENSE NO. 12788.
 ● DENOTES FOUND IRON MONUMENT.

The bearings shown hereon are based on the assumption that the north line of the Northeast Quarter of Section 9, Township 109, Range 18 has a bearing of South 88 degrees 49 minutes 27 seconds West.

200 0 200 400 600

Scale in Feet

JOHNSON & SCOFIELD INC.
LAND SURVEYORS
 1203 MAIN ST.-RED WING-MN 56066 (651) 388-1558
 WABASHA COUNTY SURVEYOR-WABASHA COUNTY COURTHOUSE
 WABASHA-MN 56981 (651) 665-3244

SEC. 9, T. 109 N., R. 18 W.