

MAP
OF
ROSCOE.
GOODHUE COUNTY,
MIN. TER.

Roscoe is situated on the N. W. quarter of Sec. 29 & N. E. corner of Sec. 30 Township 109 North of Range 46 West. Being 17 1/2 rods each side of sec. line and 220 rods south on said section line. Lots are 66 feet by 132. Alleys 16 1/2 wide. Scale of 330 feet to an inch. Stones are placed at places marked X. I certify the foregoing Plat to be correct to the best of my knowledge.

Truman Beckwith
Surveyor

Registry of deeds,
Goodhue County No. 5 }
I hereby certify
that the within Plat of Roscoe
was filed in this office for Record
on the 9th day of July A.D. 1857 and
duly Recorded in Book 1 of Town plat
J. H. Hancock
Register of deeds
By Jas. T. Chamberlain
Deft

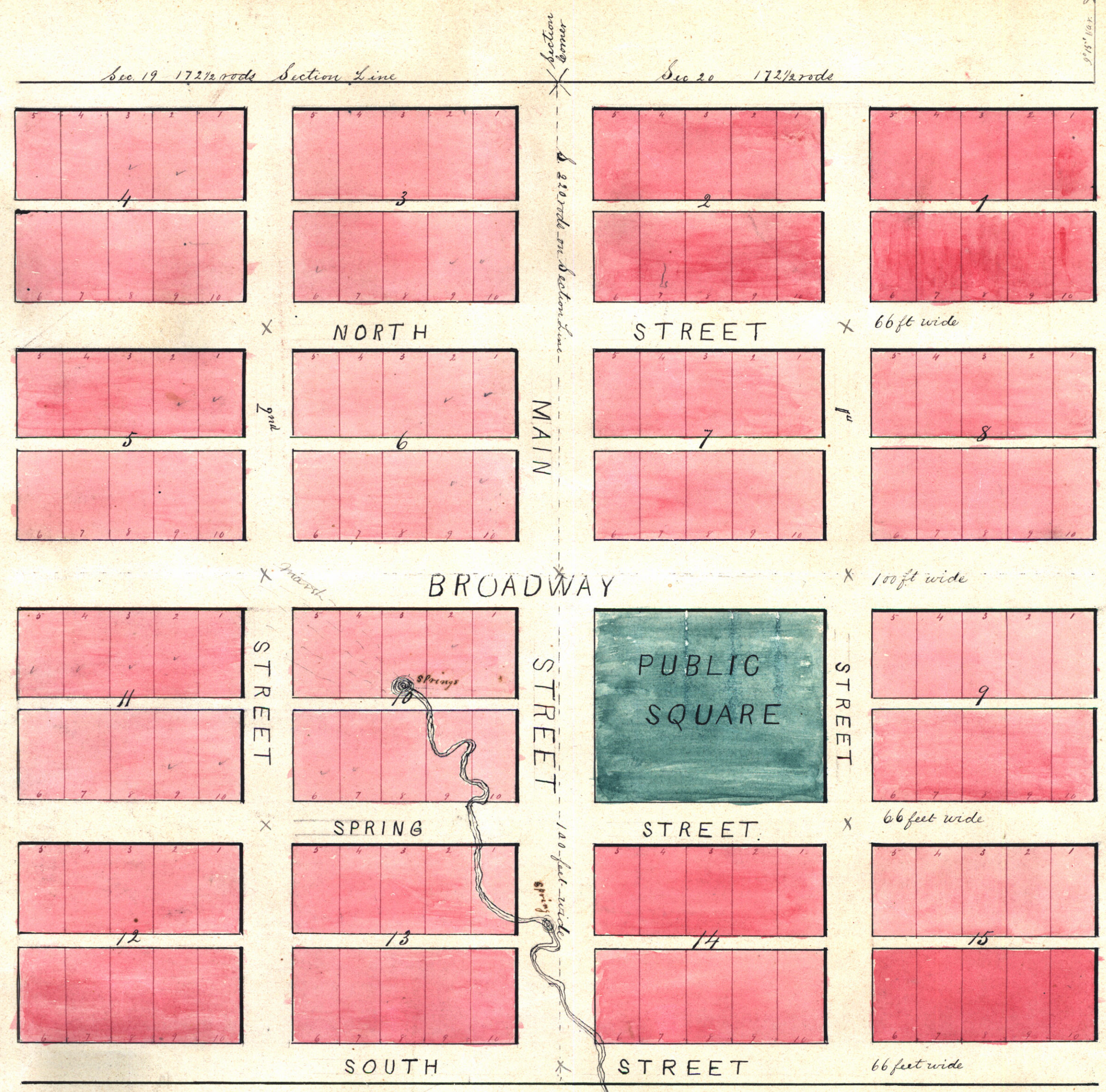

We hereby certify that we being the Proprietors of the town of Roscoe have caused the same to be laid out as here platted and we hereby give for public use and benefit all the streets and alleys and public square therein named.
Witness
James T. Chamberlain
Jas. R. Parker
Fletcher Keagler
Jacob R. Good

Territory of Minnesota }
County of Goodhue No. 5 }
Be it known that on this
9th day of July A.D. 1857 before me personally came
Fletcher Keagler and Jacob R. Good the signers and
sealers of the foregoing deed of streets and alleys &c. to
the public and acknowledged the same to be their own
free act and deed.
Jas. T. Chamberlain
Notary Public

MAP
OF
NORTH PINE ISLAND.

We the Proprietors of North Pine Island do hereby certify that we caused the same to be laid out as here platted for town purposes and do hereby give for public use the streets and alleys herein named.
Witness present }
John Salmon }
Edmund Wilcox }
Wm. R. Wilcox }
J. L. Lindsay }

Territory of Minnesota }
County of Goodhue }
Be it known that on this the second day of September A.D. 1857 personally appeared before me William R. Wilcox and J. L. Lindsay the signers of the plat of North Pine Island and acknowledged the same to be their own free act given under my hand
John Salmon
Justice of the Peace

The Plat of North Pine Island comprises the N. 1/2 of N. W. 1/4 of section No. 32 in Township No. 109 N. of Range No. 15 W. of 5th P. M. Also all that portion of the N. E. 1/4 of N. E. 1/4 of section No. 31 in the same Township and Range which lies East of the North Middle Branch of the lumber River supposed to be two acres be the same more or less. Washington and Main streets are each 80 ft wide. Broadway is 90 ft wide, all other streets are each 66 ft wide. The alleys are each 16 ft wide. Regular blocks are 300 ft square and are subdivided into lots 14 1/2 ft by 66 ft. Fractional blocks and lots are of the dimensions marked upon this Plat.

I hereby certify this map to be correct according to my survey of the town site of North Pine Island made for Wilcox & Lindsay August 1857
J. H. Beck
Surveyor

